

CELESTE/GEMINI 48/60/72

Series 8930, 8935, 8940, 8945, 8950, and 8955

BUILT-IN DIRECE VENT GAS FIREPLACES

OEM Models# BI-48-ST, BI60-ST, BI-72-ST, BI-48-SSL
BI-48-SSR, BI-60-SSL, BI-60-SSR, BI-72-SSL, BI-72-SSR

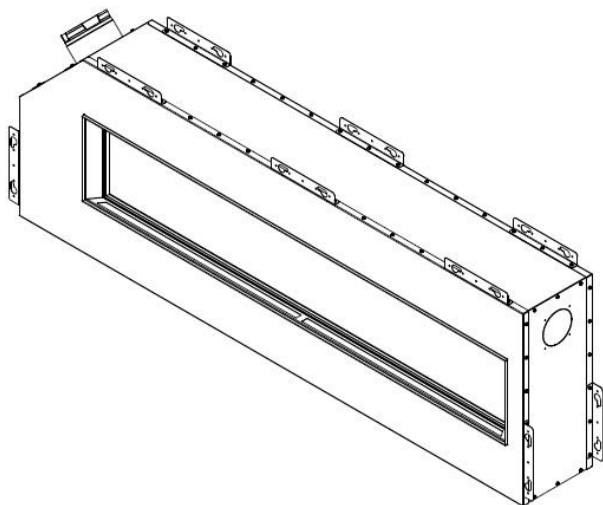

Owner's Manual Installation & Operating Instructions

Read This Manual in Its Entirety
Operate and Maintain This Gas Heater
According to This Instruction Manual.

SAVE THESE INSTRUCTIONS





Report #0361GF006S

WARNING:

FIRE OR EXPLOSION HAZARD

Failure to follow safety warnings exactly could result in serious injury, death, or property damage.

-  Do not store or use gasoline or other flammable vapors and liquids in the vicinity of this or any other appliance.
-  **WHAT TO DO IF YOU SMELL GAS:**
 - Do not try to light any appliance.
 - Do not touch any electrical switch; do not use any phone in your building.
 - Leave the building immediately.
 - Immediately call your gas supplier from a neighbor's phone. Follow the gas supplier's instructions.
 - If you cannot reach your gas supplier, call the fire department or 911.
-  A qualified installer, service agency, or gas supplier must perform installation and service of this appliance. In the Commonwealth of Massachusetts, all installation of gas lines and gas fittings must be performed by a licensed gas fitter or licensed plumber.

DANGER



HOT GLASS WILL CAUSE BURNS.

DO NOT TOUCH GLASS UNTIL COOLED.

NEVER ALLOW CHILDREN TO TOUCH GLASS.

A barrier designed to reduce the risk of burns from the hot viewing glass is provided with this appliance and shall be installed for the protection of children and other at-risk individuals.

California Prop 65

 **WARNING:** This product can expose you to chemicals including glass wool fiber and carbon monoxide which are known to the State of California to cause cancer, birth defects or other reproductive harm. For more information go to www.P65Warnings.ca.gov

Ce manuel est disponible en Francais a
www.hearthstonetech.com

INDEX

IMPORTANT SAFETY INFORMATION.....	4
MODEL LIST.....	6
SPECIFICATIONS.....	8
CLEARANCES.....	10
INSTALLATION INFORMATION.....	13
VENTING.....	15
FINAL ASSEMBLY.....	21
LIGHTING & OPERATION.....	24
GAS CONVERSION.....	33
MAINTENANCE LOG FORMS.....	37
INSTALLATION RECORD.....	38
CONTROL SYSTEM SCHEMATIC.....	40
TROUBLESHOOTING.....	41
WARRANTY INFORMATION.....	43

WE STRONGLY SUGGEST THAT YOU READ THIS MANUAL THOROUGHLY BEFORE BEGINNING THE INSTALLATION OF THE CELESTE AND GEMINI PRODUCT LINES. ALTHOUGH THE BASIC REQUIREMENTS FOR THE INSTALLATION OF ALL DIRECT VENT GAS FIREPLACES ARE SIMILAR, EACH SPECIFIC PRODUCT HAS ITS OWN UNIQUE SET-UP AND INSTALLATION REQUIREMENTS THAT MUST BE FOLLOWED EXACTLY. PLAN YOUR INSTALLATION IN ADVANCE BY CAREFULLY REVIEWING ALL THE INFORMATION CONTAINED IN THIS MANUAL.



POÊLE AU GAZ À VENTILATION DIRECTE**Manuel de l'Utilisateur****Lire ce Manuel en Entier**

Utiliser et Entretenir ce Poêle au Gaz
selon ce Manuel d'Instructions

CONSERVER CES INSTRUCTIONS!

**AVERTISSEMENT:****RISQUE D'INCENDIE OU D'EXPLOSION**

**Le non-respect des avertissements de sécurité
serait exactement entraîner des blessures graves,
la mort ou des dommages matériels.**

-  Ne pas entreposer ni utiliser d'essence ni d'autre vaperurs ou liquides inflammables dans le voisinage de cet appareil ou de tout autre appareil.
-  **QUE FAIRE SI VOUS SENTEZ UNE ODEUR DE GAZ:**
 - Ne pas tenter d'allumer d'appareil.
 - Ne touchez à aucun interrupteur. Ne pas vous servir des téléphones se trouvant dans le bâtiment où vous vous trouvez.
 - Quittez le bâtiment immédiatement.
 - Appelez immédiatement votre fournisseur de gaz depuis un voisin. Suivez les instructions du fournisseur.
 - Si vous ne pouvez rejoindre le fournisseur de gaz, appelez le service des incendies
-  L'installation et l'entretien doivent être assurés par un installateur ou un service d'entretien qualifié ou par le fournisseur de gaz.

**DANGER**

**UNE VITRE CHAUDE PEUT
CAUSER DES BRÛLURES.**

**NE PAS TOUCHER UNE
VITRE AVANT QU'ELLE NE
REFROIDISSE.**

**NE JAMAIS LAISSER UN
ENFANT TOUCHER À LA VITRE.**

Une barrière de sécurité est recommandée pour réduire les risques de brûlures causées par la vitre chaude de cet appareil et doit être installée pour la protection des enfants et d'autres personnes à risque.

IMPORTANT SAFETY INFORMATION

The installation must conform with local codes or, in the absence of local codes, with the National Fuel Gas Code, ANSI Z223.1/NFPA 54, or the Natural Gas and Propane Installation Code, CSA B149.1.

A manufactured home (USA only) or mobile home OEM installation must conform with the Manufactured Home Construction and Safety Standard, Title 24 CFR, Part 3280 or when such a standard is not applicable, the Standard for Manufactured Home Installations, ANSI/BCSBCS A225.1, or Standard for Gas Equipped Recreational Vehicles and Mobile Housing, CSA Z240.4.

The appliance and its appliance main gas valve must be disconnected from the gas supply piping system during any pressure testing of that system at test pressures in excess of 1/2 psi (3.5 kPa).

The appliance must be isolated from the gas supply piping system by closing its equipment shutoff valve during any pressure testing of the gas supply piping system at test pressures equal to or less than 1/2 psi (3.5 kPa).

The installation must provide for adequate ventilation air to the appliance.

This gas appliance must not be connected to a chimney flue serving a separate solid-fuel burning appliance.

The appliance, when installed, must be electrically grounded in accordance with local codes, or, in the absence of local codes, with the National Electrical Code ANSI/NFPA 70, or the Canadian Electrical Code, CSA C22. 1.

The appliance area must be kept clear and free from combustible materials, gasoline and other flammable vapors and liquids.

The flow of combustion and ventilation air must not be obstructed. Adequate accessibility clearances must be maintained for servicing and proper operation of this appliance.

Do not use this appliance if any part has been under water. Immediately call a qualified service technician to inspect the appliance and to replace any part of the control system and any gas control which has been under water.

Due to high temperatures, the appliance should be located out of traffic and away from furniture and draperies.

Children and adults should be alerted to the hazards of high surface temperatures and should stay away to avoid burns or clothing ignition.

Young children should be carefully supervised when they are in the same room as the appliance. Toddlers, young children and others may be susceptible to accidental contact burns. A physical barrier is recommended if there are at-risk individuals in the house. To restrict access to a fireplace or stove, install an adjustable safety gate to keep toddlers, young children and other at-risk individuals out of the room and away from hot surfaces.

A barrier designed to reduce the risk of burns from the hot viewing glass is provided with this appliance and shall be installed for the protection of children and other at-risk individuals.

If the barrier becomes damaged, the barrier shall be replaced with the manufacturer's barrier for this appliance.

Clothing or other flammable material should not be placed on or near the appliance.

Any screen or guard removed for servicing an appliance must be replaced prior to operating the appliance.

Installation and repair should be done by a qualified service person. The appliance should be inspected before use and at least annually by a professional service person. More frequent cleaning may be required due to excessive lint from carpeting, bedding material, etc. It is imperative that the control compartments, burners and circulating air passageways of the appliance be kept clean.

WARNING: Do not operate the appliance with the glass door assembly removed, or if the glass is cracked or broken. Replacement of the glass should be done by a qualified service person.

WARNING: Use only glass assembly, P/N 48-510 which includes the glass panel, frame and gasket. Do not use substitute materials. Do not strike or slam the glass front. Do not use abrasive cleaners. Do not clean when hot.

CAUTION: DO NOT OPERATE WITH BROKEN GLASS

Installation and repair should be done by a qualified service person. The appliance should be inspected before use and at least annually by a professional service person. More frequent cleaning may be required due to excessive lint from carpeting, bedding material, etc. It is imperative that the control compartment, burners and circulating air passageways of the appliance be kept clean.

Note:

Periodically conduct a visual check to ensure the pilot and burner flames are as shown (right).

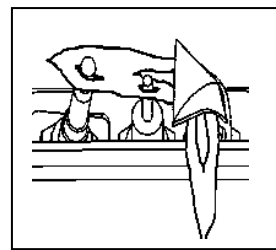
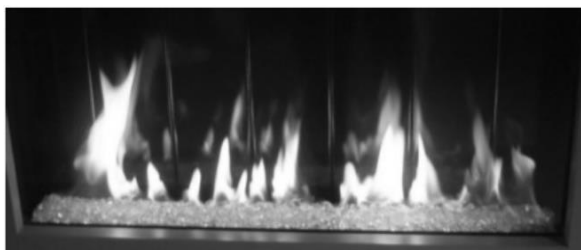

Vent Installation Note:

When the first piece of direct vent pipe is attached to the starter collar of the fireplace, be sure to inspect both the inside and outside joints to ensure a secure fit with no air gaps. Once it is confirmed there are no gaps, rotate the pipe clockwise to lock it in place. Follow the vent manufacture's installation instructions during vent pipe installation.

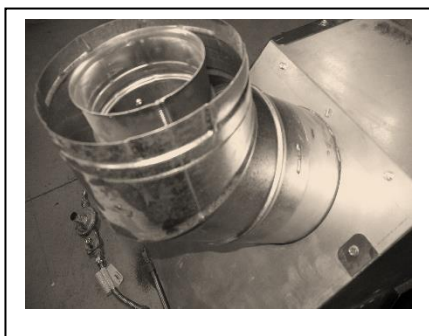

GEMINI 48 – SEE-THRU FIREPLACE

Model# 8930-0000

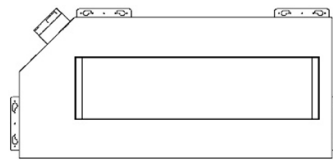
**CELESTE 48 – SINGLE SIDE FIREPLACE**

Left side vent exit

Model# 8935-0000L

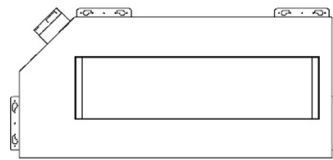
**CELESTE 48 – SINGLE SIDE FIREPLACE**

Right side vent exit

Model# 8935-0000R

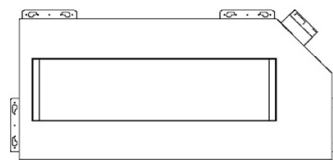
**GEMINI 60 – SEE-THRU FIREPLACE**

Model# 8940-0000

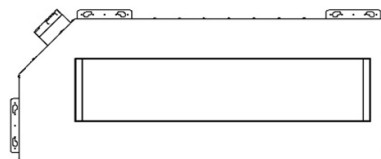
**CELESTE 60 – SINGLE SIDE FIREPLACE**

Left side vent exit

Model# 8945-0000L

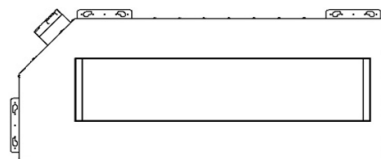
**CELESTE 60 – SINGLE SIDE FIREPLACE**

Right side vent exit

Model# 8945-0000R

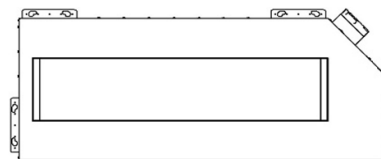
**GEMINI 72 – SEE-THRU FIREPLACE**

Model# 8950-0000

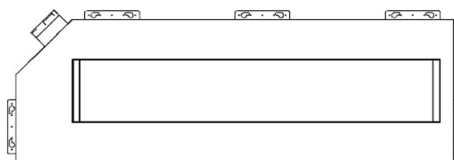
**CELESTE 72 – SINGLE SIDE FIREPLACE**

Left side vent exit

Model# 8955-0000L

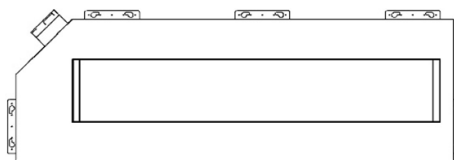
**CELESTE 72 – SINGLE SIDE FIREPLACE**

Right side vent exit

Model# 8955-0000R

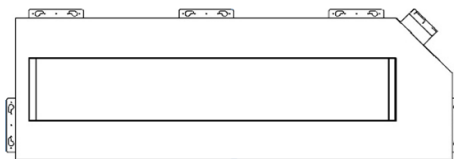

CERTIFICATION

This appliance has been certified by OMNI-Test Laboratories, Inc. to ANSI Z21.88-2014/CSA 2.33-2014 Vented Gas Fireplace Heaters and CAN/CGA-2.17-M91 (R2014), Gas-Fired Appliances for Use At High Altitudes.

This AURORA Gas Fireplace is approved for installation at elevations up to 2000 feet in the U.S. and 1370 meters (4500 feet) in Canada without change. If your installation is at an elevation greater than these, consult with the local authority having jurisdiction for gas product installations to determine their specific requirements for high altitude installations.

These appliances are approved for installation in the Commonwealth of Massachusetts by the Board of State Examiners of Plumbers and Gas Fitters

hearthstone – DIRECT VENT GAS FIREPLACES			
VENTED GAS FIREPLACE HEATER NOT FOR USE WITH SOLID FUEL		SERIAL NUMBER: _____	
GEMINI/CELESTE 48 <input type="checkbox"/> 8930-0000 <input type="checkbox"/> 8935-0000L <input type="checkbox"/> 8935-0000R EQUIPPED FOR - <input type="checkbox"/> Natural Gas/Gaz Naturel <input type="checkbox"/> Propane - ÉQUIPÉ POUR			
Input Rating	26,000 BTU/hr	30,000 BTU/hr	Debit Calorifique
Min. Input Rating	16,000 BTU/hr	19,000 BTU/hr	Puissance Minimum
Orifice - DMS	#42	#52	L'injecteur
Manifold Pressure	3.9" w.c. / 1.0kPa	10.0" w.c. / 2.5kPa	Press. A la tubulure
Min. Supply Pressure	5.5" w.c. / 1.4kPa	11.0" w.c. / 2.8kPa	Press. D'Arrivée Min.
Max Supply Pressure	10.0" w.c. / 2.5kPa	13.0" w.c. / 3.3kPa	Press. D'Arrivée Max.
For use only with barrier(s) Part No. 11223. Follow installation instructions.			
A utiliser uniquement avec des barrière(s) Référence 11223. Suivez les instructions d'installation			
GEMINI/CELESTE 60 <input type="checkbox"/> 8940-0000 <input type="checkbox"/> 8945-0000L <input type="checkbox"/> 8945-0000R EQUIPPED FOR - <input type="checkbox"/> Natural Gas/Gaz Naturel <input type="checkbox"/> Propane - ÉQUIPÉ POUR			
Input Rating	30,000 BTU/hr	34,000 BTU/hr	Debit Calorifique
Min. Input Rating	21,000 BTU/hr	25,000 BTU/hr	Puissance Minimum
Orifice - DMS	#49	#56	L'injecteur
Manifold Pressure	3.9" w.c. / 1.0kPa	10.0" w.c. / 2.5kPa	Press. A la tubulure
Min. Supply Pressure	5.5" w.c. / 1.4kPa	11.0" w.c. / 2.8kPa	Press. D'Arrivée Min.
Max Supply Pressure	10.0" w.c. / 2.5kPa	13.0" w.c. / 3.3kPa	Press. D'Arrivée Max.
For use only with barrier(s) Part No. 11218. Follow installation instructions.			
A utiliser uniquement avec des barrière(s) Référence 11218. Suivez les instructions d'installation			
GEMINI/CELESTE 72 <input type="checkbox"/> 8950-0000 <input type="checkbox"/> 8955-0000L <input type="checkbox"/> 8955-0000R EQUIPPED FOR - <input type="checkbox"/> Natural Gas/Gaz Naturel <input type="checkbox"/> Propane - ÉQUIPÉ POUR			
Input Rating	34,000 BTU/hr	40,000 BTU/hr	Debit Calorifique
Min. Input Rating	27,000 BTU/hr	28,000 BTU/hr	Puissance Minimum
Orifice - DMS	#46	#55	L'injecteur
Manifold Pressure	3.9" w.c. / 1.0kPa	10.0" w.c. / 2.5kPa	Press. A la tubulure
Min. Supply Pressure	5.5" w.c. / 1.4kPa	11.0" w.c. / 2.8kPa	Press. D'Arrivée Min.
Max Supply Pressure	10.0" w.c. / 2.5kPa	13.0" w.c. / 3.3kPa	Press. D'Arrivée Max.
For use only with barrier(s) Part No. 11226. Follow installation instructions.			
A utiliser uniquement avec des barrière(s) Référence 11226. Suivez les instructions d'installation			
MINIMUM CLEARANCES TO COMBUSTIBLE CONSTRUCTION DISTANCES MINIMALES PAR RAPPORT AUX MATÉRIELS INFLAMMABLES			
FIREPLACE SIDES	4" (102mm)	FOYER CÔTÉS	
FIREPLACE TOP	4" (102mm)	FOYER TOP	
FIREPLACE FLOOR*	1/2" (13mm)	FOYER DE CHAUSSEE*	
FIREPLACE BACK (SINGLE SIDED)	2" (51mm)	FOYER RETOUR (UNIQUE CÔTÉ)	
FIREPLACE BACK (SEE-THRU)	12" (305mm)	FOYER RETOUR (VOIR-PAR)	
FIREPLACE FRONT	12" (305mm)	FOYER AVANT	
CLEARANCE AROUND VENT PIPE	1.5" (38mm)	JEU AUTOUR VENT PIPE	
*1/2" non-combustible under fireplace floor must have R factor of no less than 0.37			
*13mm non-combustible sous cheminée plancher doit avoir facteur R de pas moins de 0.37			
<p>This product has been certified by OMNI-Test Laboratories to ANSI Z21.88-2014 / CSA 2.33-2014 Vented Gas Fireplace Heaters, and CAN/CGA 2.17-M91 (2014), Gas-Fired Appliance For Use At High Altitudes. This appliance is equipped only for altitudes from 0-2000 feet (0-610m). In Canada 0-4500 feet (0-1370m). This appliance must be installed in accordance with local codes, if any; if none, follow the National Fuel Gas Code, ANSI Z223.1/NFPA 54, or Natural Gas and Propane Installation Codes, CSA-B149.1.</p> <p>This appliance is for use only with the type of gas indicated on the rating plate. This appliance may be installed in an aftermarket, permanently located manufactured home (USA only) or in a mobile home, where not prohibited by local codes. See Owner's Manual for details.</p> <p>This appliance is not field convertible for use with other gases, unless a certified conversion kit is used.</p> <p>This appliance may be recessed 12.5 inches within combustible construction.</p> <p>This appliance may be installed with a combustible mantle of no more than 12 inches deep at a minimum of 14.25 inches above the fireplace opening.</p> <p>NOT FOR USE WITH GLASS DOORS.</p> <p>HRD-750 – Heat Redistribution Blower Kit may be used with this appliance.</p>			



Manufactured for:
hearthstone
 Quality Home Heating Products
 HearthStone Q-H-P, Inc.
 MORRISVILLE, VERMONT 05661

by:
 Progressive Manufacturing Inc.
 4 Technology Drive, Suite 5
 West Lebanon, NH 03784
 U.S.A.

hearthstone – DIRECT VENT GAS FIREPLACES	
CAUTION: HOT WHILE IN OPERATION. DO NOT TOUCH. SEVERE BURNS MAY RESULT. KEEP CHILDREN, CLOTHING, FURNITURE, GASOLINE, AND OTHER LIQUIDS HAVING FLAMMABLE VAPORS AWAY. CAUTION: Do not operate the appliance with the glass removed, cracked, or broken. Replacement of the glass panel(s) should be done by a licensed or qualified service person. See the Owner's Manual. CAUTION: Label all wires prior to disconnection when servicing. Wiring errors can cause improper and dangerous operation. Verify Proper operation after servicing. Electrical rating – Total input of all components is less than 2.5 amperes. WARNING: Improper installation, adjustment, alteration, service, or maintenance can cause injury or property damage. Refer to the owner's information manual provided with this appliance. For assistance or additional information, consult a qualified installer, service agency, or the gas supplier. This appliance must be properly connected to a venting system in accordance with the manufacturer's installation instructions. Keep burner and control compartments clean. See installation and operating instructions accompanying appliance. This vented fireplace is not for use with air filters.	
<p>Ce produit a été testé et répertorié OMNI-Test Laboratories conformément au ANSI Z21.88-2014 / CSA 2.33-2014, CAN/CGA 2.17-M91 (2014), et CSA P.4.1-09. Cet appareil peut être utilisé à des altitudes comprises entre 0 et 610m (0 et 2000 pieds) (E.U. seulement) ou entre 0 et 1370m (0 et 4500 pieds) (Canada seulement) sans modification. Installez l'appareil selon les codes ou règlements, ou dans l'absence de tels règlements, selon les codes d'installation, ANSI Z223.1 National Fuel Gas Code, ou CSA-B149.1 en vigueur. Cet appareil doit être correctement raccordé à un système d'évacuation conformément aux instructions du fabricant.</p> <p>Cet appareil peut être installé dans une maison préfabriquée (E.-U. seulement) ou mobile déjà installée à demeure si les règlements locaux le permettent. Voir la notice de l'utilisateur pour plus de renseignements. Cet appareil doit être utilisé uniquement avec les types de gaz indiqués sur la plaque signalétique. Cet appareil ne peut pas être utilisé avec d'autres gaz sauf si une trousse de conversion certifiée est fournie.</p> <p>Cet appareil peut être encastré 318mm au sein de construction combustible.</p> <p>Cet appareil peut être installé avec un manteau combustible de pas plus de 305mm de profondeur à un minimum de 362 au-dessus de l'ouverture du foyer.</p> <p>NE PAS UTILISER AVEC PORTES EN VERRE</p> <p>HRD-750 – Heat Redistribution Blower Kit peut être utilisé avec cet appareil.</p>	
ATTENTION: L'appareil est chaud lorsqu'il fonctionne. Ne pas toucher l'appareil. Risque de brûlures graves surveiller les enfants. Garder les vêtements, les meubles, l'essence ou autres liquides produisant des vapeurs inflammables loin de l'appareil. AVERTISSEMENT: Une installation, un réglage, une modification, une réparation ou un entretien mal effectué peut causer des dommages matériels ou des blessures. Voir la notice de l'utilisateur qui accompagne l'appareil. Pour de l'aide ou des renseignements supplémentaires, consultez un installateur, un technicien agréé ou le fournisseur de gaz.	
ATTENTION: Avant de le faire des réparations, marquez tous les fils avant de les débrancher. Les erreurs avec le circuit électronique peuvent causer des fonctionnements dangereux et incorrects.	
ATTENTION: Ne pas utiliser l'appareil si le panneau frontal en verre n'est pas en-place, est craqué ou brisé. Confiez le remplacement de panneau à un technicien agréé. S'assurer que le brûleur et le compartiment des commandes sont propres. Voir les instructions d'installation et d'utilisation qui accompagnent l'appareil. Ne pas utiliser de filtre à air avec ce foyer au gaz évacuation.	



FABRIQUÉ POUR:
hearthstone
 Quality Home Heating Products
 HearthStone Q-H-P, Inc.
 MORRISVILLE, VERMONT 05661

PAR:
 Progressive Manufacturing Inc.
 4 Technology Drive, Suite 5
 West Lebanon, NH 03784
 U.S.A.

Sample Rating Label (affixed to control panel within firebox)

SPECIFICATIONS

NATURAL GAS SPECIFICATION CHART			
INPUT	CELESTE/GEMINI 48	CELESTE/GEMINI 60	CELESTE/GEMINI 72
Input Rating BTU/Hr.	26,000	30,000	34,000
Min. Input BTU/Hr.	16,000	21,000	27,000
Orifice Size - DMS	#42	#49	#46
GAS SUPPLY	CELESTE/GEMINI 48	CELESTE/GEMINI 60	CELESTE/GEMINI 72
Manifold Pressure	3.5" w.c. / 0.9kPa	3.5" w.c. / 0.9kPa	3.5" w.c. / 0.9kPa
Min. Supply Pressure	5.5" w.c. / 1.4kPa	5.5" w.c. / 1.4kPa	5.5" w.c. / 1.4kPa
Max. Supply Pressure	10.0" w.c. / 2.5kPa	10.0" w.c. / 2.5kPa	10.0" w.c. / 2.5kPa

PROPANE (LP) SPECIFICATION CHART			
INPUT	CELESTE/GEMINI 48	CELESTE/GEMINI 60	CELESTE/GEMINI 72
Input Rating BTU/Hr.	30,000	34,000	40,000
Min. Input BTU/Hr.	19,000	25,000	28,000
Orifice Size – DMS	#52	#56	#55
GAS SUPPLY	CELESTE/GEMINI 48	CELESTE/GEMINI 60	CELESTE/GEMINI 72
Manifold Pressure	10.0" w.c. / 2.5kPa	10.0" w.c. / 2.5kPa	10.0" w.c. / 2.5kPa
Min. Supply Pressure	11.0" w.c. / 2.8kPa	11.0" w.c. / 2.8kPa	11.0" w.c. / 2.8kPa
Max. Supply Pressure	13.0" w.c. / 3.3kPa	13.0" w.c. / 3.3kPa	13.0" w.c. / 3.3kPa

Efficiency NG/LP	CEL/GEM 48	CEL/GEM 60	CEL/GEM 72
*Typical Installation, Steady State Efficiency - %	62.2/68.4	69/73.9	72.6/76.4
Steady State Efficiency - %	61/63.4	64.8/70.8	70.4/74.8
Annual Fuel Utilization Efficiency (AFUE) - %	59/61.4	62.8/68.6	68.2/72.5
Canadian p.4 Efficiency - %	65.7/62	64.5/67.7	69.8/72.7

**Your efficiency will increase with the length of the vent run. The typical installation tested is 5ft vertical and 5ft horizontal.*

NOTE: The maximum achievable steady state efficiency can vary depending on how the fireplace is installed and operated.

- It is recommended that the pilot flame be turned off if the appliance will not be in use for an extended period of time.
- This appliance is equipped for use with the fuel type indicated on the rating plate. Field conversion is only permitted with a conversion kit supplied by Hearthstone.

SPECIFICATIONS

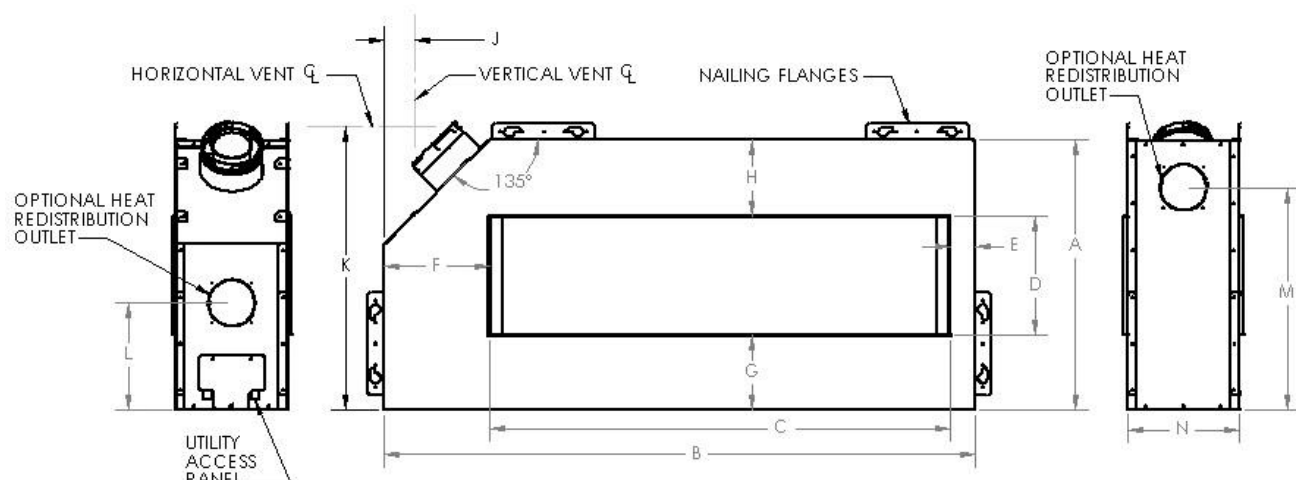

	GEMINI/CELESTE 48	GEMINI/CELESTE 60	GEMINI/CELESTE 72
Dimension "A"	29" (737mm)	29" (737mm)	29" (737mm)
Dimension "B"	63.625" (1,616mm)	73.625" (1,870mm)	87.625" (2,226mm)
Dimension "C"	49.25" (1,251mm)	59.25" (1,505")	73.25" (1,861mm)
Dimension "D"	12.75" (324mm)	12.75" (324mm)	12.75" (324mm)
Dimension "E"	2.70" (69mm)	2.70" (69mm)	2.70" (69mm)
Dimension "F"	11.30" (287mm)	11.30" (287mm)	11.30" (287mm)
Dimension "G"	7.95" (202mm)	7.95" (202mm)	7.95" (202mm)
Dimension "H"	8.125" (206mm)	8.125" (206mm)	8.125" (206mm)
*Dimension "J"	3.25" (83mm)	3.25" (83mm)	3.25" (83mm)
*Dimension "K"	30.25" (768.5mm)	30.25" (768.5mm)	30.25" (768.5mm)
Dimension "L"	11.50" (292mm)	11.50" (292mm)	11.50" (292mm)
Dimension "M"	23.875" (606.5mm)	23.875" (606.5mm)	23.875" (606.5mm)
Dimension "N"	12" (305mm)	12" (305mm)	12" (305mm)

*The Horizontal and Vertical vent centerline dimensions' account for the use of a 45-degree elbow.

The gas fireplace is shipped with a 3/8" tube OD (female) connection. The gas supply piping should have a separate gas shutoff valve and a 1/8" NPT plugged tapping upstream of the valve. The stove and its main control valve must be disconnected from the gas supply piping system during any pressure testing of that system at test pressures in excess of 1/2 psi (3.5 kPa). The stove must be isolated from the gas supply piping system by closing the main control valve during any pressure testing of the gas supply system at test pressures equal to or greater than 1/2 psi (3.5 kPa). After the gas supply has been connected, use a commercial gas leak detector or apply a soapy water solution to all the fittings to check for gas leaks. Never use a flame to test for leaks.

CLEARANCES

MINIMUM CLEARANCES TO COMBUSTIBLE CONSTRUCTION			
	GEMINI/CELESTE 48	GEMINI/CELESTE 60	GEMINI/CELESTE 72
Sides	4" (102mm)	4" (102mm)	4" (102mm)
Floor	1/2" (13mm)	1/2" (13mm)	1/2" (13mm)
Back (Single Sided)	2" (51mm)	2" (51mm)	2" (51mm)
Back (See-Thru)	12" (305mm)	12" (305mm)	12" (305mm)
Front	12" (305mm)	12" (305mm)	12" (305mm)
Clearance around vent pipe	1.5" (38mm)	1.5" (38mm)	1.5" (38mm)

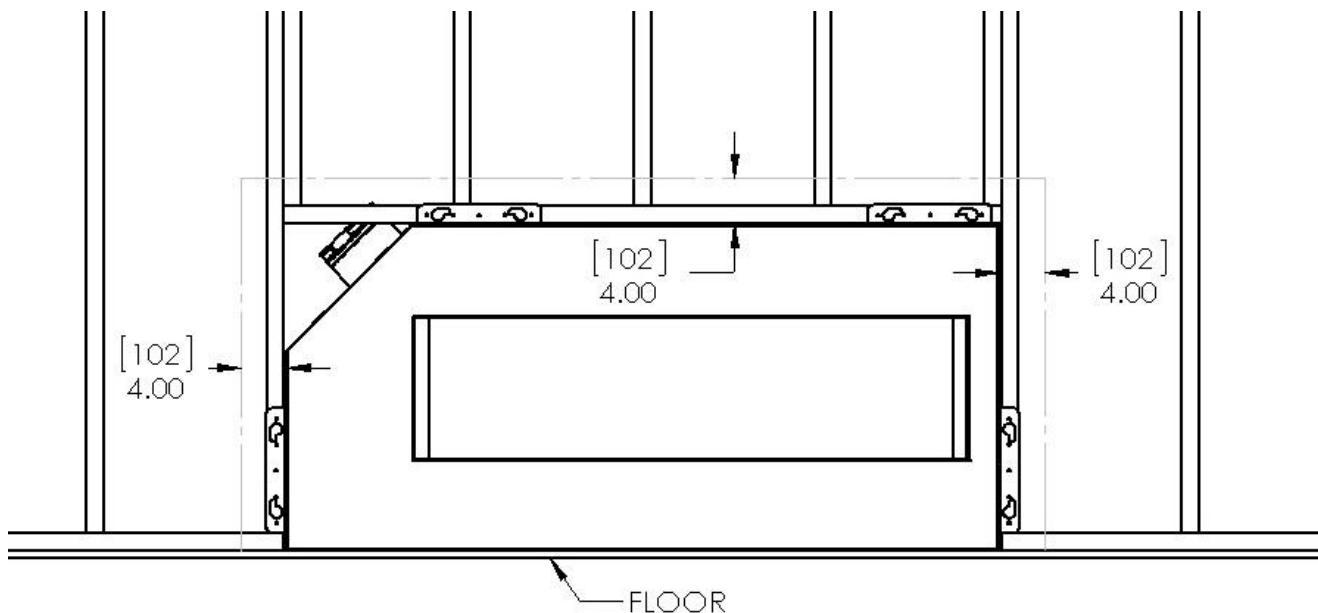

The image above shows a typical installation.

- All framing, finishing, and construction materials that fall within 4" (102mm) of either the sides or top of the fireplace must be non-combustible and 1/2" below the unit.
- Any materials that cover the front face or rear face of the fireplace must be non-combustible. Allow clearance for removal of fireplace trim, screen, and glass.
- The fireplace must be secured to the framing studs using the nailing flanges as shown above. Use 2 screws or nails per nailing flange to secure the fireplace.
- The sheet metal face of this fireplace must be covered by a non-combustible material, it may not be left exposed.
- The floor the fireplace immediately rests on must be constructed of non-combustible material with an R factor of at least .37, with a minimum thickness of 1/2" (13mm).

FRAMING BEFORE INSTALLATION

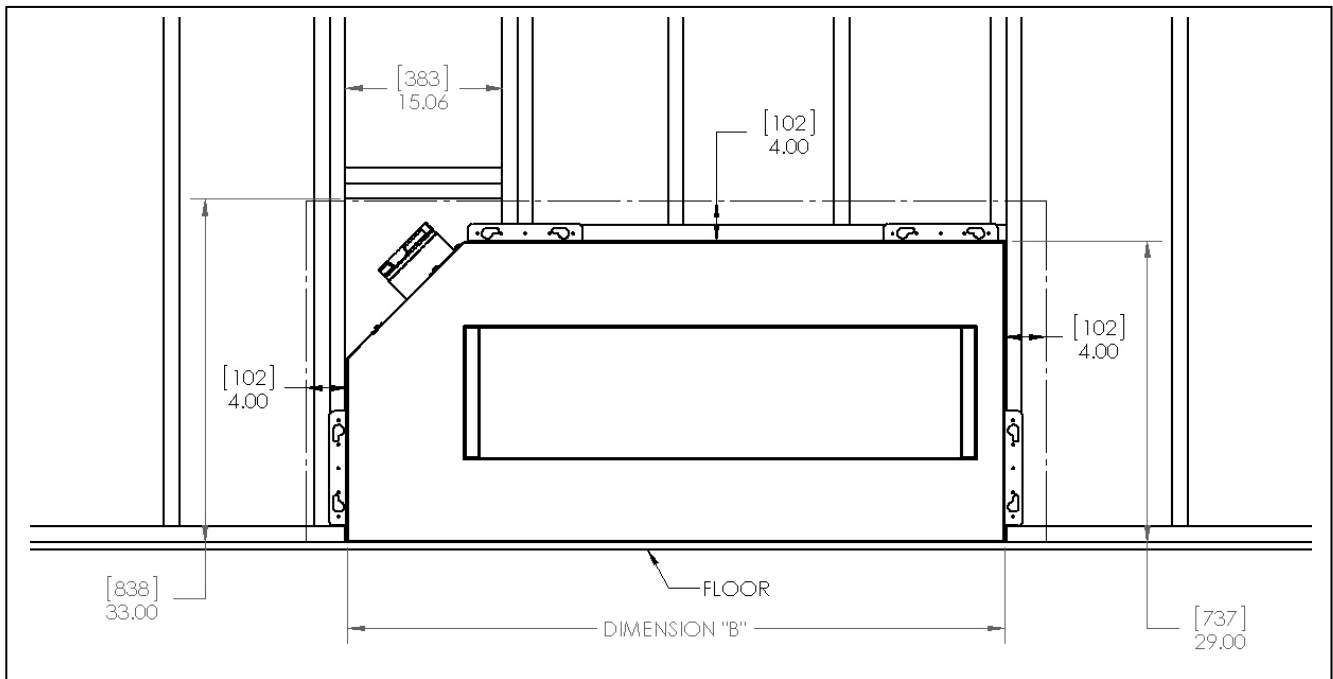

Sometimes it is necessary to frame the location you will be installing the fireplace before the fireplace is onsite, the above image shows an example of how to frame the wall before the fireplace is moved into position.

- All framing, finishing, and construction materials that fall within 4" (102mm) of either the sides or top of the fireplace must be non-combustible. (shown with a dashed line in the image above)
- Note that the vent starter collar sits slightly above the top surface of the fireplace can, there must be clearance to allow the fireplace with starter collar to slide into place.
- The floor the fireplace immediately rests on must be constructed of non-combustible material with an R factor of at least .37, with a minimum thickness of ½" (13mm).
- This framing guide is just an example of the many ways in which a AURORA Fireplace can be installed. You may need to customize this framing design to allow for things such as doors, windows, countertops, structural frame members or local code requirements.
- Dimension "B" for your model can be found on page .

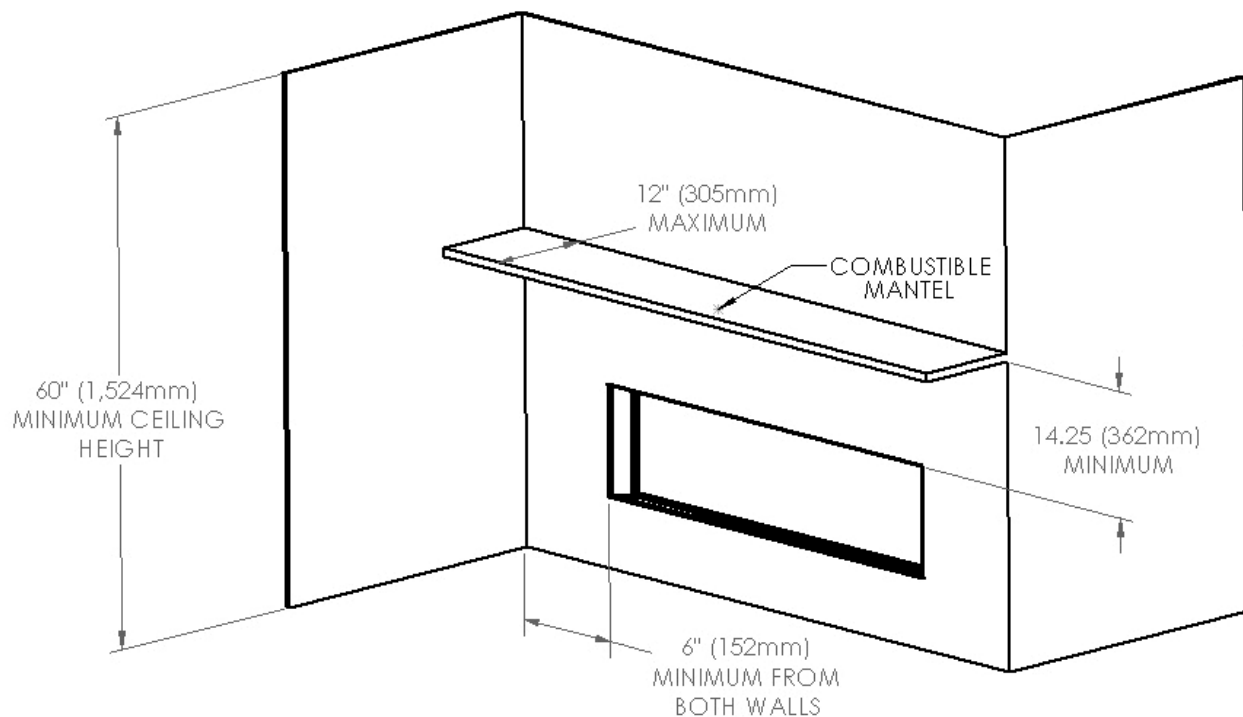
**WARNING**

Follow these instructions carefully to ensure safe installation. Failure to follow instructions exactly can create a fire hazard.

- The combustible area above the facing must not protrude more than $\frac{3}{4}$ (19mm) from the facing; if it does, it is considered a mantel and must meet the mantel requirements on the following page.
- When selecting non-combustible materials for use in the installation, take note of the material's propensity to absorb and conduct heat. Materials such as metal, stone, and ceramics may transmit heat more readily than other building materials.
- Only non-combustible materials (i.e. brick, tile, slate, steel, or other man made materials with a UL fire rating of Zero) may be used in the construction and installation of this fireplace. Any material must be fastened to surrounding framing. NOT to the face of the fireplace.

ATTENTION:

Before proceeding with your installation, determine if you plan to use either the Power Vent kit (99-65350 horizontal or 99-653352 vertical) or the Heat Redistribution Kit (99-57350). Read the manual for these optional components before proceeding with your installation, as your installation requirements and procedure may change.

INSTALLATION INFORMATION

WARNING

Read all instructions completely and thoroughly before attempting installation. Failure to do so could result in serious injury, property damage, or loss of life. Operation of improperly installed or maintained venting system could result in serious injury, property damage, or loss of life.

NOTE: Any electrical wiring, gas plumbing, or vent installation required by the appliance must be done prior to final finishing. The unit shall be test burned on high for at least 30 minutes prior to final finishing to confirm proper operation. Failure to test the appliance before final finishing may require significant and costly reconstruction

INSTALLATION PRECAUTIONS:

Consult local building codes before beginning the installation. The installer must make sure to select the proper vent system for installation. Before installing the vent kit, the installer must read this fireplace manual and vent kit instructions. Only a qualified, licensed, installer/service person shall install the venting system. The installer must follow the following safety rules:

- Wear gloves and safety glasses for protection.
- Use extreme caution when using ladders or when on rooftops.
- Be aware of electrical wiring locations in walls and ceilings.

The following actions will void the warranty on your fireplace:

- Installation of any damaged venting component.
- Unauthorized modification of the venting system.
- Installation of any component part not manufactured or approved by Hearthstone.
- Installation other than permitted by these instructions.

NOTICE: Failure to follow these instructions will void the warranty.

State of Massachusetts:

The installation must be completed by a licensed plumber or gas fitter in the Commonwealth of Massachusetts.

REQUIREMENTS FOR THE COMMONWEALTH OF MASSACHUSETTS

This product must be installed by a licensed plumber or gas fitter when installed within the Commonwealth of Massachusetts. If this appliance is installed in a dwelling, building or structure used in whole or in part for residential purposes and the installation includes a horizontal vent termination that is less than seven (7) feet above the finished grade in the area of the venting, including but not limited to decks and porches, a hard-wired carbon monoxide detector with an alarm and battery back-up must be installed on the floor level of the dwelling, building or structure where the appliance is to be installed.

Additionally, a hard-wired or battery operated carbon monoxide detector with an alarm must be installed on each additional level of the dwelling, building or structure served by the appliance. It shall be the responsibility of the property owner to secure the services of qualified licensed professionals for the installation of hard-wired carbon monoxide detectors.

In the event that the horizontally vented appliance is installed in a crawl space or attic, the hard-wired carbon monoxide detector with alarm and battery back-up may be installed on the next adjacent floor level.

In the event that this requirement cannot be met at the time of completion of the installation of the appliance, the owner shall have a period of thirty (30) days to comply with the requirement. However, during said thirty (30) day period, a battery operated carbon monoxide detector with alarm must be installed.

Each carbon monoxide detector as required in accordance with the above provisions must comply with NFPA 720 and be ANSI/UL 2034 and IAS certified.

In addition, when the vent termination is less than seven (7) feet above finished grade a metal or plastic identification plate must be permanently mounted to the exterior of the building at a minimum height of eight (8) feet above grade directly in line with the exhaust vent terminal. The sign shall read, in print size no less than one-half (1/2) inch in size, "GAS VENT DIRECTLY BELOW. KEEP CLEAR OF ALL OBSTRUCTIONS".

A COPY OF THESE INSTRUCTIONS PLUS ALL VENTING INSTRUCTIONS WHICH INCLUDE PARTS LISTS, AND/OR ALL VENTING DESIGN INSTRUCTIONS MUST REMAIN WITH THE STOVE AT THE COMPLETION OF THE INSTALLATION.

ATTENTION INSTALLERS: Mark below which venting system was used in the installation. These instructions must remain with the AURORA Gas Fireplace Installation & Operation Manual.

☐ Simpson DuraVent GS/PRO®

☐ Selkirk Direct-Temp®

☐ Security Secure Vent™

☐ AmeriVent Direct™

☐ Metal Fab Direct Vent

☐ ICC Direct Vent

VENTING

WARNING

This fireplace must be vented to the outside. The venting system must NEVER be attached to a chimney serving a separate solid fuel burning appliance. Each gas appliance must use a separate vent system. Do not use common vent systems.

INSTALLATION PLANNING

The GEMINI and CELESTE 48, 60, and 72 use 4x6 Direct-vent pipe. There are two basic types of direct-vent installation:

- Horizontal Termination
- Vertical Termination

It is important to select the proper length of vent pipe for the type of termination you choose, taking into consideration wall thicknesses.

FOR HORIZONTAL TERMINATION

Select the amount of vertical rise desired. All horizontal run of venting must have $\frac{1}{4}$ " rise for every 12" of horizontal run.

WARNING

Never run the vent pipe level or downward. This may cause excessive temperatures which could cause a fire.

FOR VERTICAL TERMINATION

Measure the distance from the Horizontal Vent Center Line (see diagram on page 8). Add the ceiling thickness, the vertical rise in an attic or second story, and allow for sufficient vent height above the roofline.

NOTE:

You may use two 45° elbows in place of a 90° elbow. You must follow rise to run ratios when using 45° elbows. The appliance is approved for use with three 90° elbows maximum of a combination of 90° and 45° elbows up to a maximum of 270°.

For two-story applications, firestops are required at each floor level. If an offset is needed in the attic, additional pipe and elbows will be required.

It is very important that the venting system maintain its balance between the combustion air intake and the flue gas exhaust. Certain limitations apply to vent configurations and must be strictly followed.

INSTALLING A VENT SYSTEM IN AN OUTSIDE CHASE

A chase is a vertical box like structure built to enclose venting that runs along the outside of a building. A chase is required for such venting.

NOTICE

Treatment of firestops and construction of the chase may vary from building type to building type. These instructions are not substitutes for local building code requirements.

NOTICE

When installing in a chase, you should insulate the chase as you would the outside walls of your home. This is especially important in cold climates. Insulation should be considered a combustible material. Maintain proper clearances to combustibles.

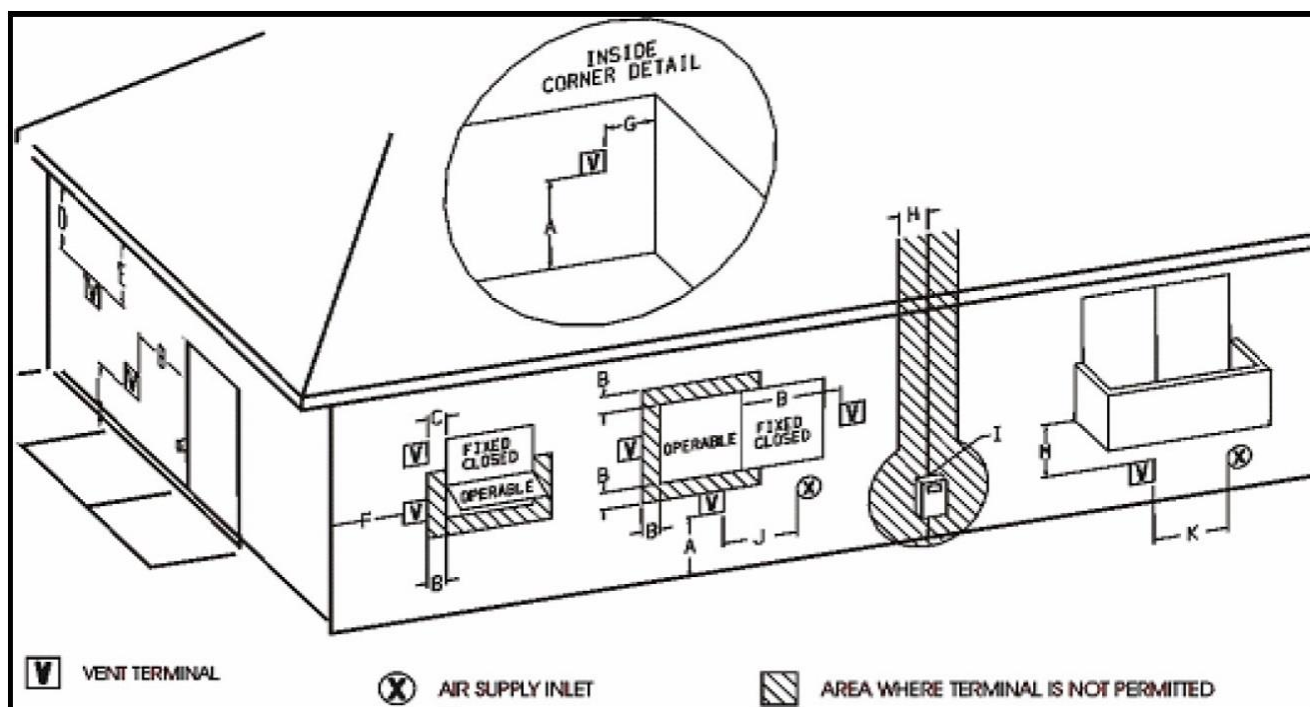

	Canadian Installations ¹	U.S. Installations ²
A = Clearance above grade, veranda, porch, deck or balcony	12 inches (30 cm)	12 inches (30 cm)
B = Clearance to window or door that may be opened	12 inches (30 cm)	9 inches (23 cm)
C = Clearance to a permanently closed window	See Footnotes 5 & 6	See Footnote 5
D = Vertical clearance to a ventilated soffit located above the terminal within a horizontal distance of 2 feet (61 cm) from the centerline of the terminal	See Footnotes 5 & 6	See Footnote 5
E = Clearance to unventilated soffit	See Footnotes 5 & 6	See Footnote 5
F = Clearance to outside corner	See Footnotes 5 & 6	See Footnote 5
G = Clearance to inside corner	See Footnotes 5 & 6	See Footnote 5
H = Clearance to each side of centerline extended above meter/regulator assembly	3 feet (91 cm) within a height of 15 feet (4.5 m) above the regulator/meter assembly	See Footnote 5
I = Clearance to service regulator vent outlet	3 feet (91 cm)	See Footnote 5
J = Clearance to non-mechanical air supply inlet to building or the combustion air inlet to any other appliance	12 inches (30 cm)	9 inches (23 cm)
K = Clearance to a mechanical air supply inlet	6 feet (1.83 m)	3 feet (91 cm) above if within 10 feet (3 m) horizontally
L = Clearance above paved sidewalk or paved driveway located on public property	7 feet (2.12 m)	See Footnote 5
M = Clearance under veranda, porch, deck or balcony	12 inches (30 cm) See Footnote 4	See Footnote 5

Footnotes

- ¹ In accordance with the current CSA B419.1, Natural Gas and Propane Installation Code
- ² In accordance with the current ANSI Z223.1 / NFPA 54, National Fuel Gas Code
- ³ A vent shall not terminate directly above a sidewalk or paved driveway that is located between two single family dwellings and serves both dwellings.
- ⁴ Permitted only if veranda, porch, deck or balcony is fully open on a minimum of two sides below the floor.
- ⁵ Clearance in accordance with local installation codes and the requirements of the gas supplier.
- ⁶ Dégagement conforme aux codes d'installation locaux et aux exigences du fournisseur de gaz.

Install a Simpson DuraVent (Or equivalent) wall thimble where the pipe passes through a wall to retain any insulation in the wall and to maintain proper clearances. If

the wall being penetrated is constructed of non-combustible material only (i.e., Masonry block or concrete), the wall thimble is not required; and a hole with zero clearance is acceptable (6 $\frac{5}{8}$ " hole).

NOTICE:

Venting terminals shall not be recessed into a wall or siding.

This AURORA Gas Fireplace has been tested and listed for installation with 4" X 6 $\frac{5}{8}$ " M&G DuraVent GS/Pro®, Selkirk Direct-Temp®, Security Secure Vent™, AmeriVent Direct™, Metal Fab Direct Vent and ICC EXCELDirect venting components. Although you may use the pipe components (straight pipe, elbows, etc.) from any of the listed manufacturers, you may only use the vent terminations (caps) listed in the chart on the following page. For installations where a snorkel is needed, please note that only three snorkels are approved for use. Please plan your installation accordingly.

For all specific venting installation requirements, follow the installation instructions included by the venting manufacturer with the venting system components you have chosen.

PLEASE NOTE:

- It is assumed that the installation will include at least one 90° elbow. Up to three additional 90° elbows (or equivalent 45° elbows) may also be used. The total venting may not exceed 20 feet of vertical rise and/or 10 feet horizontal run. Refer to the venting charts on pages 20 for specific details while you plan your installation. Note: The number of elbows impacts the maximum allowable horizontal vent run.
- There should be a 1 $\frac{1}{2}$ " overlap of the vent and combustion air tubes, when telescopic joints are used.
- The location of the vent termination must meet the requirements of the current edition of ANSI Z223.1/NFPA 54, National Fuel Gas Code or CAN B419.1, Natural Gas and Propane Installation Code and the requirements shown on page 16 of this manual.

APPROVED VENT TERMINATIONS	M&G DURAVENT GS/PRO	SELKIRK DIRECT-TEMP	SECURITY SECURE VENT	AMP AMERIVENT DIRECT	METAL FAB DIRECT VENT	ICC EXCELDIRECT
VERTICAL CAP	46DVAVCH	1604802	SV4CGC	4DVC	4DVT	TM4VT
HORIZONTAL CAP	46DVAHC 46DVAHRCS 46DVAHSC	1604804	SV4GHC	4DVHC	4DHT	TM4HT TM4DHT
SNORKEL	N/A	1604836	N/A	4D36C	N/A	TMST36

Just as with any other vented device, vertical vent rise creates draft (negative pressure) in the firebox as the exhaust gases heat up. If this draft becomes excessive, it can affect the performance or appearance of the fire. The AURORA Gas Fireplace includes an integrated air restrictor that can be used to balance the draft in the fireplace to the optimal level for installations where excessive draft might occur. The AURORA Gas Fireplace will ship from the factory with the air restrictor set to the #1 position. If the licensed fireplace installer determines that draft reduction is necessary, loosen the fastener on the dial and make small adjustments from #1 to #4 until a satisfactory result has been achieved.

The air restrictor dial is located on the flue side of the firebox when viewed from the front. To access, remove the lower air screen and side panels. Once satisfied with the air restrictor adjustment, secure its position by tightening all hardware.

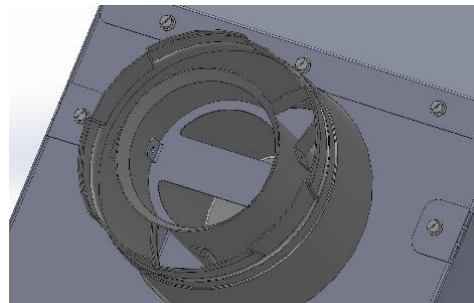
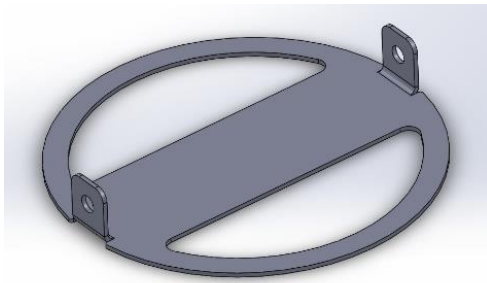

AURORA flue restrictor kit (CONTACT Hearthstone for part number)

Some vent configurations may create excess draft within the fireplace. Excess draft can cause issues such as a rapid, or “nervous” flame picture, undesirable flame color, or pilot lifting which may prevent the fireplace from staying lit. In these circumstances it may be necessary to install the flue restrictor in the venting system. It is permissible to install this restrictor at the vent cap should the venting system already be installed. Secure the restrictor plate with the included #10 sheet metal screws.

GEMINI 48 flue baffle kit (CONTACT Hearthstone for part number)

Certain vent configurations for the GEMINI 48, particularly those with a significant amount of vertical in relation to the amount of horizontal vent pipe, may cause the flame to be unbalanced, or biased toward the flue outlet side of the fireplace. Installation of this flue baffle will help to resolve this issue. It may be necessary to use this restrictor on its own, or in addition to the AURORA flue restrictor kit shown above. This flue baffle kit snaps into the fireplace as shown below.

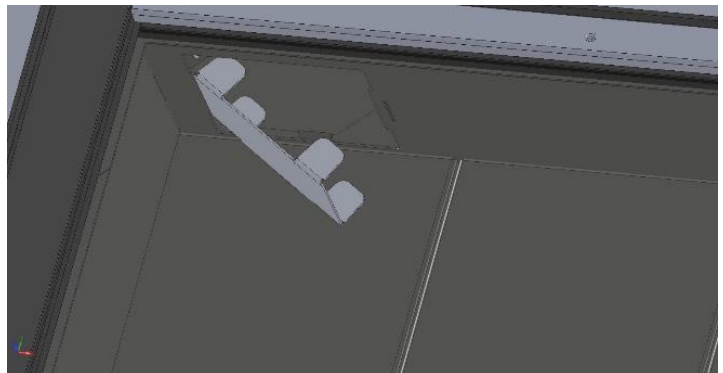
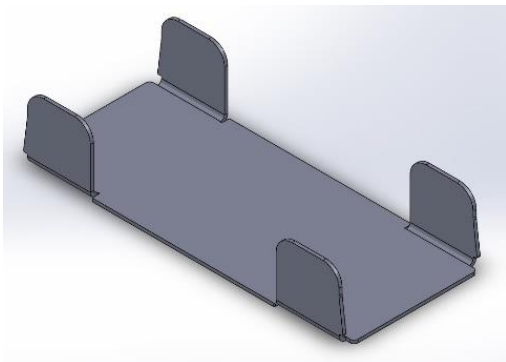
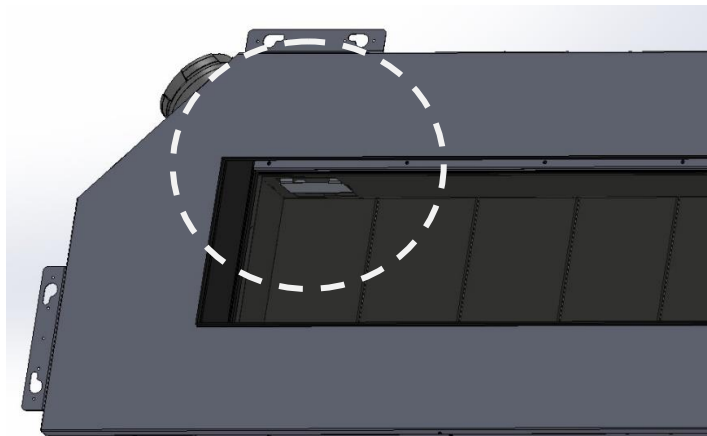

Use this worksheet to determine the equivalent horizontal run for use with the vent charts on the next page. The information contained within this worksheet may also be useful during installation or in the event that you need technical assistance from Hearthstone.

- A. FUEL TYPE ☐ NATURAL GAS ☐ LP GAS (PROPANE)
- B. TOTAL VERTICAL VENT RISE (MEASURED FROM HORIZONTAL CENTERLINE OF VENT OPENING ON THE BACK OF THE FIREPLACE TO THE HORIZONTAL CENTERLINE OF THE VENT CAP (FOR HORIZONTAL VENT CAPS) OR TO THE FLANGE ON THE CAP (FOR VERTICAL CAPS): _____ FEET
- C. TOTAL HORIZONTAL VENT RUN (MEASURED FROM THE VENT STARTER ON THE FIREPLACE TO THE FLANGE ON THE CAP (FOR HORIZONTAL CAPS) OR TO THE VERTICAL CENTERLINE OF THE CAP (FOR VERTICAL CAPS)): _____ FEET

NOTE: THE VERTICAL VENT RISE AND HORIZONTAL VENT RUN ARE THE OFFSETS IN THE LOCATIONS OF VENT CAP RELATIVE TO THE VENT OPENING ON THE FIREPLACE. VENT PIPE THAT RUNS AT 45° HAVE BOTH A VERTICAL RISE AND HORIZONTAL RUN. SNORKEL CAPS HAVE BUILT-IN VERTICAL RISE THAT MUST BE COUNTED.

- D. TOTAL NUMBER OF 90° ELBOWS: _____ NOTE: SNORKELS COUNT AS 2- 90° ELBOWS
- E. TOTAL NUMBER OF 45° ELBOWS: _____

HORIZONTAL VENT RUN EQUIVALENT CALCULATOR

- C. Total horizontal vent run (actual): _____
- D. 90° Elbows needed: _____
- E. 45° Elbows needed: _____
- F. Total 90° Elbows equivalent: $D + (E \times \frac{1}{2}) =$ _____
- G. 90° Elbows in excess or 2: F-2 = _____
- H. Additional horiz. feet (equivalent): Gx3 = _____
- I. Horizontal vent run (equivalent): C+H = _____

TERMINATION (CAP) TYPE: ☐ HORIZONTAL ☐ VERTICAL ☐ SNORKEL

VENT BRAND:

- ☐ Simpson DuraVent GS/PRO® ☐ Selkirk Direct-Temp® ☐ Security Secure Vent™
- ☐ AmeriVent Direct™ ☐ Metal Fab Direct Vent ☐ ICC Direct Vent

VENT CAP MODEL NO: _____ NOTE: SEE APPROVED VENT CAPS ON THE PREVIOUS PAGE.

WAS THE FIREPLACE INSTALLED WITH A N AURORA POWER VENT? (CIRCLE ONE) Y N

Vent chart for the GEMINI and CELESTE 48

VERTICAL VENT RUN (Ft)	HORIZONTAL VENT RUN (Ft)															
	0	1	2	3	4	5	6	7	8	9	10	11	12	13	14	15
30	GV	GV	GV	GV	GV	GV	GV	GV	GV	GV	GV	GV	PV	PV	PV	
29	GV	GV	GV	GV	GV	GV	GV	GV	GV	GV	GV	GV	PV	PV	PV	
28	GV	GV	GV	GV	GV	GV	GV	GV	GV	GV	GV	GV	PV	PV	PV	
27	GV	GV	GV	GV	GV	GV	GV	GV	GV	GV	GV	GV	PV	PV	PV	
26	GV	GV	GV	GV	GV	GV	GV	GV	GV	GV	GV	GV	PV	PV	PV	
25	GV	GV	GV	GV	GV	GV	GV	GV	GV	GV	GV	GV	PV	PV	PV	
24	GV	GV	GV	GV	GV	GV	GV	GV	GV	GV	GV	GV	PV	PV	PV	
23	GV	GV	GV	GV	GV	GV	GV	GV	GV	GV	GV	GV	PV	PV	PV	
22	GV	GV	GV	GV	GV	GV	GV	GV	GV	GV	GV	GV	PV	PV	PV	
21	GV	GV	GV	GV	GV	GV	GV	GV	GV	GV	GV	GV	PV	PV	PV	
20	GV	GV	GV	GV	GV	GV	GV	GV	GV	GV	GV	GV	PV	PV	PV	
19	GV	GV	GV	GV	GV	GV	GV	GV	GV	GV	GV	GV	PV	PV	PV	
18	GV	GV	GV	GV	GV	GV	GV	GV	GV	GV	GV	GV	PV	PV	PV	
17	GV	GV	GV	GV	GV	GV	GV	GV	GV	GV	GV	GV	PV	PV	PV	
16	GV	GV	GV	GV	GV	GV	GV	GV	GV	GV	GV	GV	PV	PV	PV	
15	GV	GV	GV	GV	GV	GV	GV	GV	GV	GV	GV	GV	PV	PV	PV	
14	GV	GV	GV	GV	GV	GV	GV	GV	GV	GV	GV	GV	PV	PV	PV	
13	GV	GV	GV	GV	GV	GV	GV	GV	GV	GV	GV	GV	PV	PV	PV	
12	GV	GV	GV	GV	GV	GV	GV	GV	GV	GV	GV	GV	PV	PV	PV	
11	GV	GV	GV	GV	GV	GV	GV	GV	GV	GV	GV	GV	PV	PV	PV	
10	GV	GV	GV	GV	GV	GV	GV	GV	GV	GV	GV	GV	PV	PV	PV	
9	GV	GV	GV	GV	GV	GV	GV	GV	GV	GV	GV	PV	PV	PV	PV	
8	GV	GV	GV	GV	GV	GV	GV	GV	GV	GV	GV	PV	PV	PV	PV	
7	GV	GV	GV	GV	GV	GV	GV	GV	GV	GV	GV	PV	PV	PV	PV	
6	GV	GV	GV	GV	GV	GV	GV	GV	GV	GV	GV	PV	PV	PV	PV	
5	GV	GV	GV	GV	GV	GV	GV	GV	GV	GV	GV	PV	PV	PV	PV	
4	GV	GV	GV	GV	GV	GV	GV	GV	GV	GV	GV	PV	PV	PV	PV	
3	GV	GV	GV	GV	GV	GV	GV	GV	GV	GV	GV	PV	PV	PV	PV	
2	GV	GV	GV	GV	GV	GV	GV	GV	GV	GV	GV	PV	PV	PV	PV	
1	GV	GV	GV	GV	GV	PV	PV	PV	PV	PV	PV	PV	PV	PV	PV	
0	NA	PV	PV	PV	PV	PV	PV	PV	PV	PV	PV	PV	PV	PV	PV	

NA = NOT ALLOWED GV = GRAVITY VENT PV = POWER VENT

Vent chart for the GEMINI and CELESTE 60 and 72

VERTICAL VENT RUN (Ft)	HORIZONTAL VENT RUN (Ft)															
	0	1	2	3	4	5	6	7	8	9	10	11	12	13	14	15
30	GV	GV	GV	GV	GV	GV	GV	GV	GV	GV	GV	GV	PV	PV	PV	
29	GV	GV	GV	GV	GV	GV	GV	GV	GV	GV	GV	GV	PV	PV	PV	
28	GV	GV	GV	GV	GV	GV	GV	GV	GV	GV	GV	GV	PV	PV	PV	
27	GV	GV	GV	GV	GV	GV	GV	GV	GV	GV	GV	GV	PV	PV	PV	
26	GV	GV	GV	GV	GV	GV	GV	GV	GV	GV	GV	GV	PV	PV	PV	
25	GV	GV	GV	GV	GV	GV	GV	GV	GV	GV	GV	GV	PV	PV	PV	
24	GV	GV	GV	GV	GV	GV	GV	GV	GV	GV	GV	GV	PV	PV	PV	
23	GV	GV	GV	GV	GV	GV	GV	GV	GV	GV	GV	GV	PV	PV	PV	
22	GV	GV	GV	GV	GV	GV	GV	GV	GV	GV	GV	GV	PV	PV	PV	
21	GV	GV	GV	GV	GV	GV	GV	GV	GV	GV	GV	GV	PV	PV	PV	
20	GV	GV	GV	GV	GV	GV	GV	GV	GV	GV	GV	GV	PV	PV	PV	
19	GV	GV	GV	GV	GV	GV	GV	GV	GV	GV	GV	GV	PV	PV	PV	
18	GV	GV	GV	GV	GV	GV	GV	GV	GV	GV	GV	GV	PV	PV	PV	
17	GV	GV	GV	GV	GV	GV	GV	GV	GV	GV	GV	GV	PV	PV	PV	
16	GV	GV	GV	GV	GV	GV	GV	GV	GV	GV	GV	GV	PV	PV	PV	
15	GV	GV	GV	GV	GV	GV	GV	GV	GV	GV	GV	GV	PV	PV	PV	
14	GV	GV	GV	GV	GV	GV	GV	GV	GV	GV	GV	GV	PV	PV	PV	
13	GV	GV	GV	GV	GV	GV	GV	GV	GV	GV	GV	GV	PV	PV	PV	
12	GV	GV	GV	GV	GV	GV	GV	GV	GV	GV	GV	GV	PV	PV	PV	
11	GV	GV	GV	GV	GV	GV	GV	GV	GV	GV	GV	PV	PV	PV	PV	
10	GV	GV	GV	GV	GV	GV	GV	GV	GV	GV	GV	PV	PV	PV	PV	
9	GV	GV	GV	GV	GV	GV	GV	GV	GV	PV	PV	PV	PV	PV	PV	
8	GV	GV	GV	GV	GV	GV	GV	GV	GV	PV	PV	PV	PV	PV	PV	
7	GV	GV	GV	GV	GV	GV	GV	GV	GV	PV	PV	PV	PV	PV	PV	
6	GV	GV	GV	GV	GV	GV	GV	GV	GV	PV	PV	PV	PV	PV	PV	
5	GV	GV	GV	GV	GV	GV	GV	GV	GV	PV	PV	PV	PV	PV	PV	
4	GV	GV	GV	GV	GV	GV	GV	GV	PV	PV	PV	PV	PV	PV	PV	
3	GV	GV	GV	PV	PV	PV	PV	PV	PV	PV	PV	PV	PV	PV	PV	
2	GV	GV	GV	PV	PV	PV	PV	PV	PV	PV	PV	PV	PV	PV	PV	
1	GV	PV	PV	PV	PV	PV	PV	PV	PV	PV	PV	PV	PV	PV	PV	
0	NA	PV	PV	PV	PV	PV	PV	PV	PV	PV	PV	PV	PV	PV	PV	

NA = NOT ALLOWED GV = GRAVITY VENT PV = POWER VENT

Power vent runs of up to 110ft with (6) 90° elbows are permitted when using the AURORA power vent kit **PV-486072**. Refer to power vent instructions for additional power vent installation and operation information.

FINAL ASSEMBLY

SCREEN REMOVAL:

4. Lift up on the lower air panel to remove it from the fireplace opening then carefully lift up on and remove the left and right side panels.



5. The fireplace screen is held in place by 3 self-tensioning latches along its top edge (4 latches on the 72 inch models). Release these latches to remove the screen.

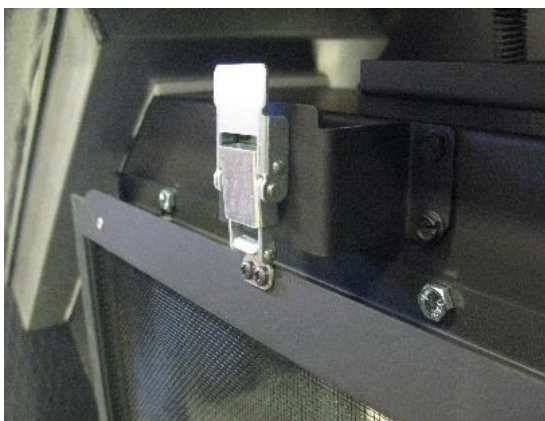

1. Allow the screen to rest in the fireplace opening, confirm that the latches are in their "home" position.

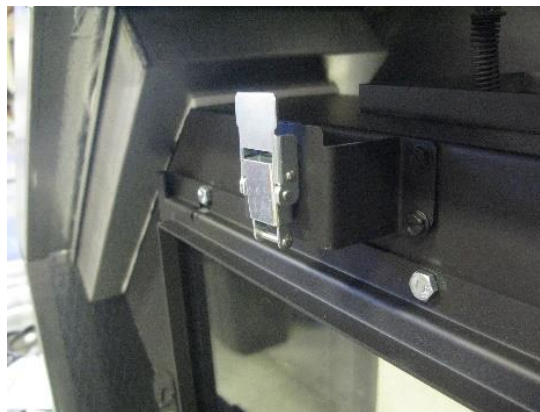

3. Lift the screen up so that the bottom of the screen clears the bottom of the fireplace opening.



2. Angle the screen toward you from the bottom to remove.

To reinstall the screen, reverse these steps. Remember to confirm the latches are in their "home" position any time you are installing or removing the screen.

NOTICE: If the screen is removed for servicing this appliance it must be replaced prior to operating the appliance.

GLASS REMOVAL:

1. With the screen removed, loosen the ¼-20 bolts along the top edge of the glass frame using a 7/16 socket.



2. Confirm that the Screen latches are in their "home" position. (see image)
3. Lift the glass frame assembly up so that the bottom of the glass frame assembly clears the bottom of the fireplace opening.



NOTICE: Do not attempt to operate the fireplace without the screen or glass frame assembly in place. Doing so could lead to injury, property damage, or loss of life.

4. Angle the glass assembly toward you from the bottom to remove.



Refer to the next page for instructions on burner media placement.

GLASS INSTALLATION:

1. Insert the glass frame assembly into the fireplace by angling the top of the glass in and up into the fireplace.



2. Lift the glass frame assembly up so that the bottom of the glass frame assembly clears the bottom of the fireplace opening.
3. Slide the glass frame into the glass frame retainer along the bottom of the firebox opening.
4. Install the ¼-20 bolts along the top edge of the glass frame assembly and tighten using a 7/16 socket.

PLACING THE BURNER GLASS MEDIA

The burner glass media poly-bag that you set aside when you unpacked the fireplace contains the correct amount of glass material to cover the burner. **DO NOT** add any additional media to the media supplied with your fireplace. The entire contents of the bag should be evenly distributed over the burner tray.

1. Locate the burner in the fireplace. Refer to the adjacent illustration.
1. Carefully clip one corner of the poly-bag to form a pouring spout. The opening should be large enough to allow the glass media to flow but not so large that you can't control the flow.
2. You will notice that the burner surface is designed with turned-up edges that form a tray to hold the glass media.
3. Starting at one end, pour the glass media onto the burner tray, keeping the pouring spout on the poly-bag toward the center of the burner to avoid spillage of glass pieces over the sides of the burner. See the adjacent illustrations.
4. Once you have poured all of the glass burner media into the burner tray, carefully smooth the glass pieces out so they have a uniform depth over the entire surface of the burner. When the burner glass media is properly placed, it should look like the adjacent illustrations.

Note: If a few pieces of glass escape over the edges of the burner tray during installation, it is not a problem. They will simply land in the area below the burner and will do no harm.

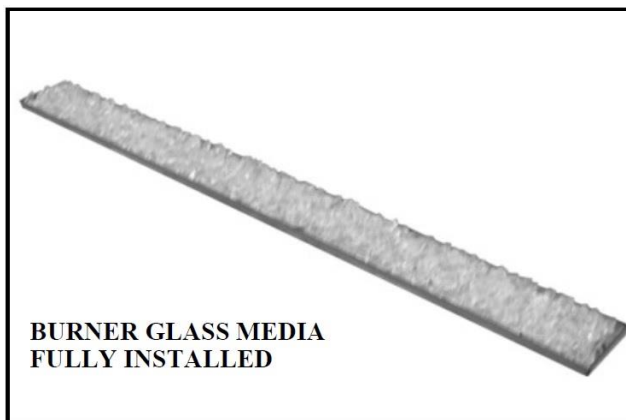
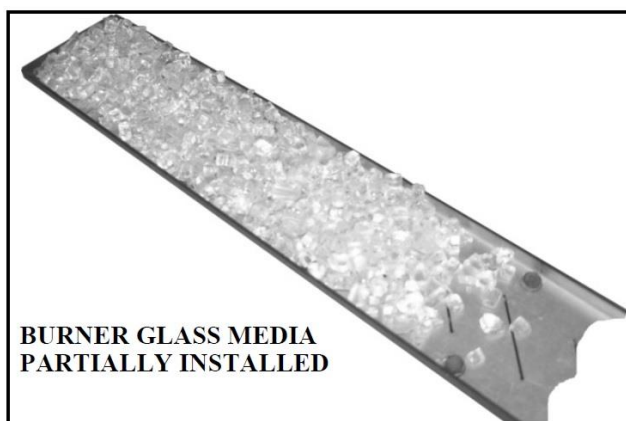
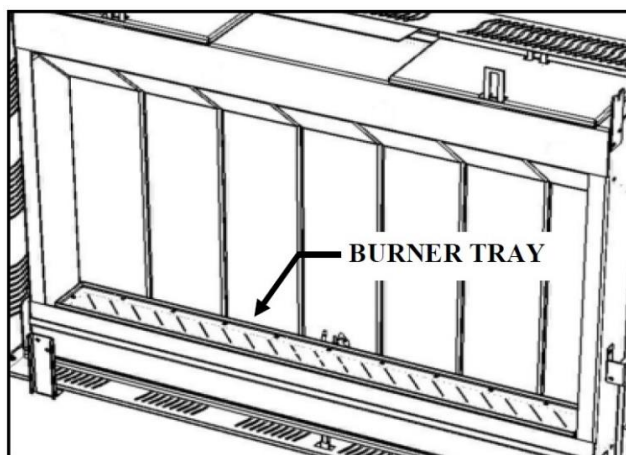

Lighting and Operation

FOR YOUR SAFETY READ BEFORE LIGHTING

WARNING: If you do not follow these instructions exactly, a fire or explosion may result causing property damage, personal injury or loss of life.



When lighting this appliance, follow these instructions exactly:

- A. This appliance is equipped with an ignition device that automatically lights the pilot. Do not try to light the pilot by hand.
- B. **BEFORE OPERATING THE BURNER SYSTEM**, smell around the appliance area for gas. Be sure to smell next to the floor because some gas is heavier than air and will settle on the floor.





WHAT TO DO IF YOU SMELL GAS

- 🔥 Do not try to light the appliance.
 - 🔥 Do not touch any electric switch; do not use any telephone in your building.
 - 🔥 Immediately call your gas supplier from a neighbor's telephone. Follow the gas supplier's instructions
 - 📞 If you cannot reach your gas supplier, call the fire department.
- C. Use only your hand to operate the gas controls. Never use tools. If a knob will not push in or turn by hand, don't try to repair it, call a qualified service technician. Force or attempted repair may result in a fire or explosion.
 - D. Do not use this appliance if any part has been under water. Immediately call a qualified service technician to inspect the appliance and to replace any part of the control system which has been under water.

OPERATING INSTRUCTIONS

1. STOP! Read the safety information above on this label.
2. This appliance is equipped with an ignition device that automatically lights the pilot. Do not try to light the pilot by hand.
3. Using the Remote Handset, or the optional Wall Switch, push the "OFF"  button until you hear an audible signal to insure the appliance is Off.
4. Wait five (5) minutes to clear out any gas. Then smell for gas including near the floor. If you smell gas, STOP! Follow "B" in the safety information above. If you don't smell gas, proceed to step 5.
5. Using either the Remote Handset, or the optional Wall Switch, simultaneously press the "ON"  and "High Flame"  buttons. An audible signal confirms the start sequence has begun.
6. Continuing beeps confirm the ignition is in process. Once lighting the pilot flame should appear as shown in Fig.2. Once the pilot is confirmed, the main burner ignites on high.

NOTE: If the pilot does not stay lit after several tries, proceed to step 9.

7. Use the flame height adjustment buttons on either the Remote Handset or the optional Wall Switch to adjust the flame. Press the  button twice to decrease the flame height to its lowest setting, press the button twice to increase flame height to the highest setting. Pressing the  or  button once will module the flame to intermediate settings. The Remote Handset can also be used to control the appliance thermostatically.
8. Press and hold the  button on the Remote Handset or optional Wall Switch to set the appliance to Pilot

flame only.

9. If the appliance will not operate, follow the instructions “TO TURN OFF GAS TO THE APPLIANCE” and call your gas service technician or gas supplier.

TO TURN OFF GAS TO THE APPLIANCE

1. To turn off gas to the appliance, push and release the  “OFF” button on either the Remote Handset or on the optional Wall Switch. You will hear an audible signal confirming the off setting.
2. TO TURN OFF THE GAS SUPPLY TO THE APPLIANCE, close the shut-off valve on the gas supply line to the appliance.

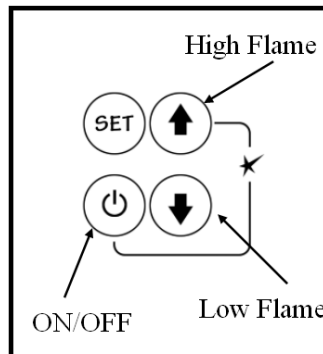

FIG. 1

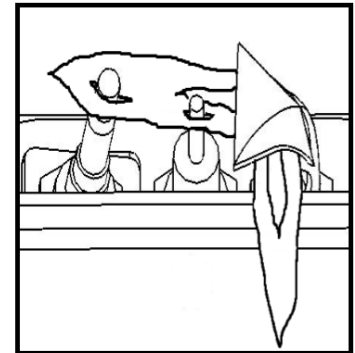

FIG. 2

OPERATING YOUR FIREPLACE FOR THE FIRST TIME

When operating your new fireplace for the first time, some vapors may be released due to the burning of curing compounds used in the manufacture of the appliance. They may cause a slight odor and could cause the flames to be the full height of the firebox, or even slightly higher, for the first few hours of operation.

It is also possible that these vapors could set off any smoke detection alarms in the immediate vicinity.

These vapors are quite normal on new appliances. We recommend opening a window to vent the room. After a few hours use, the vapors will have disappeared and the flames will be at their normal height.

FLAME SUPERVISION DEVICE

For your safety, this appliance is fitted with a flame supervision device which will shut-off the gas supply if, for any reason, the pilot flame goes out. This device incorporates a fixed probe, which senses the heat from the pilot flame. If the probe is cool, the device will prevent any gas flow unless manually lighting the pilot. See full lighting instructions. Periodically check the pilot flame and compare to figure 2 above.

LIGHTING, OPERATION AND RATING INFORMATION

The Lighting, Operation and Rating information is located on a plate under the firebox.

To access the plate, remove any fret or access panel and grab the plate and slide it out to read it. There is important information on both sides of the plate.

WARNING

DO NOT ATTEMPT TO TOUCH THE DATA PLATE WHILE THE FIREPLACE IS STILL HOT!
Let the fireplace cool first before touching it.

SERVICING

If any attention is required for your appliance, contact your dealer quoting the model number. It will be helpful if the appliance's serial number can also be quoted. This number is on the rating plate, which is located under the burner. The replacement parts are shown at the end of this manual. Please always quote the part number and description when requesting spare parts.

FIREPLACE CONTROL DEVICES

There are two ways to control your fireplace.

1. Thermostatic Remote Control
2. Optional Wall Switch

The Thermostatic Remote Control can be programmed to function automatically—see pages 34-39.

The Wall Switch (optional) can be used to turn on, off and to increase or decrease the flame height.

NOTE: The remote control in the AUTO mode will override the optional wall switch.

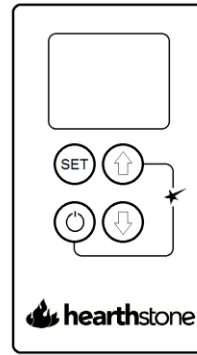

Programmable Thermostatic Remote Control

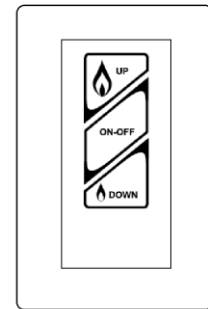

Optional Wall Switch

HOW TO TURN YOUR FIREPLACE OFF (INCLUDING PILOT)

Familiarize yourself with each of these methods before operating your fireplace.

Handset and Wall Switch: Press and hold the OFF button for a second (either on the handset or the wall switch).

If the flames are on, they go down and you hear the valve motor wind down. You hear a clunk and a beep indicating that the valve has received the signal from the remote control.

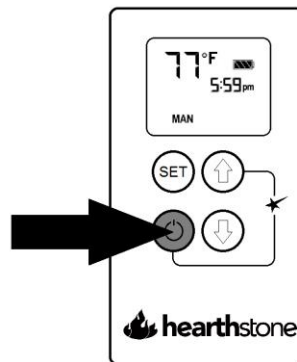

Programmable Thermostatic Remote Control

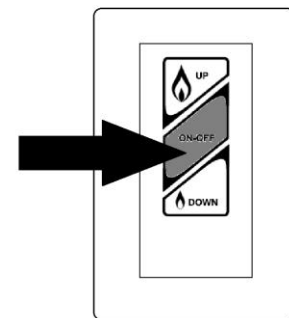

Optional Wall Switch

HOW TO ENSURE YOUR FIREPLACE CANNOT BE TURNED ON INADVERTENTLY

You can use the following method to ensure that your fireplace will not turn on when you don't want it on.

First, ensure your fireplace is turned off—including the pilot—and cold BEFORE going ahead.

- Close the shut-off valve on the gas supply line to the appliance.
- Remove all batteries from the receiver as well as the battery from the handset.

Automatic Shut-Off (in certain conditions)

Your fireplace's remote control is equipped with an automatic shut-off mechanism which is activated in certain conditions. See page 28 in the *Remote Control Operation* section for a description of this feature.

NOTE: Before using the remote control system for the first time, the receiver and the handset are synchronized at the factory. See the *Synchronizing the Remote and Valve Receiver Module* section under *Maintenance* on page 35 of this manual if the receiver and handset lose synchronization.

IMPORTANT: BEFORE YOU BEGIN, please note that on this system, the settings of time, temperature and automatic ON/OFF **can only be programmed when the function display is flashing.** Be patient when programming as it can take a few seconds to set.

Maxitrol Control System

Remote Control Layout

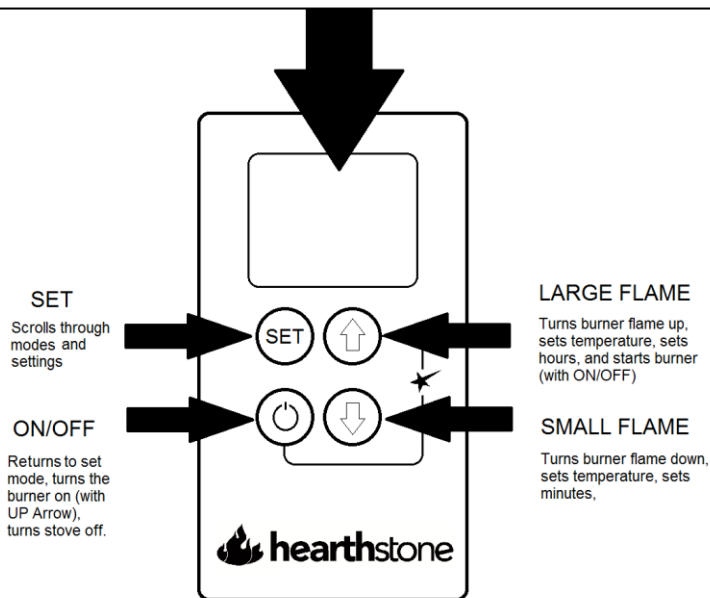
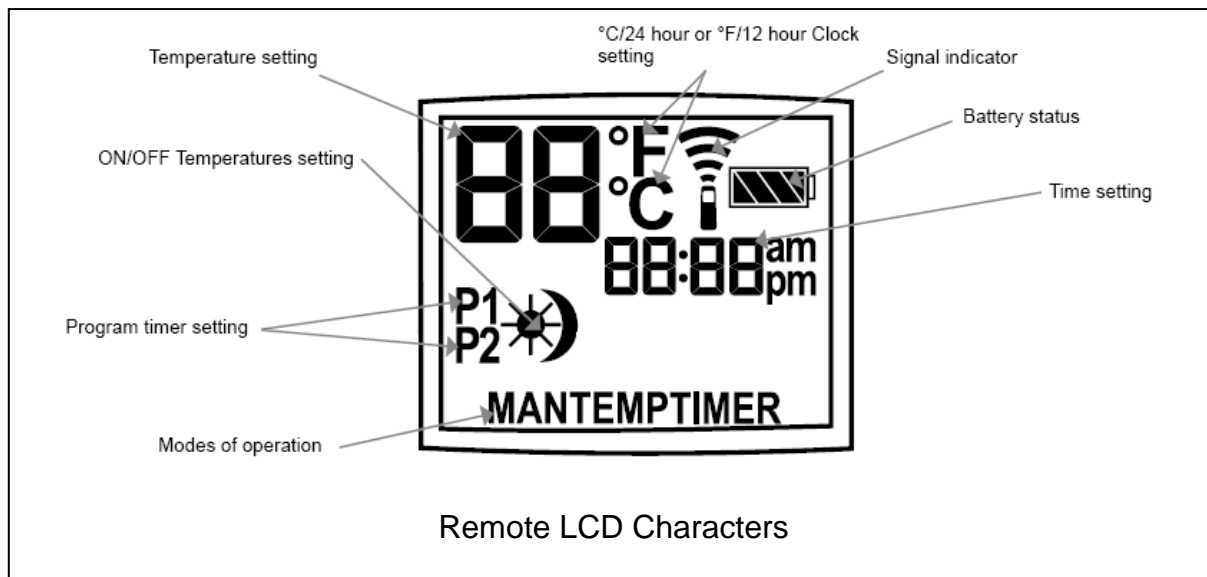

Handset Overview

Note: In the TEMP or TIMER modes, the remote handset senses the room temperature and adjusts the flame accordingly.

To communicate, the handset should be within 15 feet (4.5 meters) of the fireplace.

Do not leave the handset on the hearth, mantel, or on top of the fireplace.

BASIC REMOTE COMMANDS

TO TURN ON THE APPLIANCE

CAUTION

When pilot ignition is confirmed, motor turns automatically to maximum flame height.

- On the valve, turn MAN knob on the ON, full counterclockwise  position.

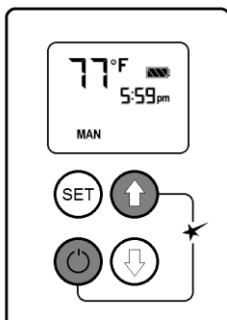

- Simultaneously press the OFF and  (large flame) buttons until a short beep confirms the start sequence has begun; release buttons.
- Continuing beeps confirm the ignition is in process.
- Once pilot ignition is confirmed, there is main gas flow.
- After main burner ignition the handset will automatically go into manual (MAN) control mode.

TO TURN OFF THE APPLIANCE

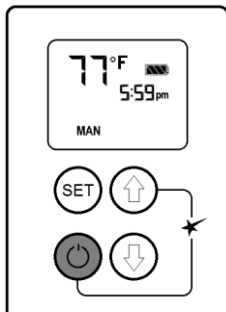

- Press OFF button.

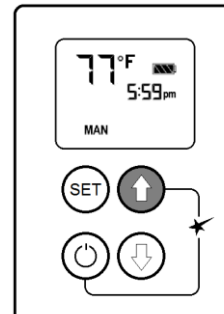

When the pilot is off, it will take 2 minutes before it can be lit again.

FLAME HEIGHT ADJUSTMENT



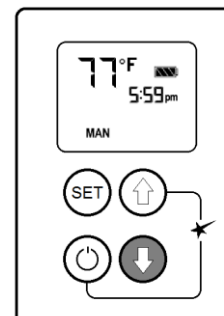

- In standby mode: Press and hold  (large flame) button to increase flame height.

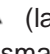

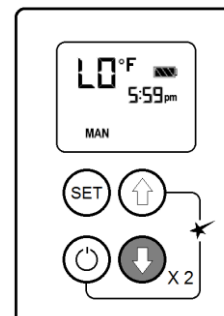

- Press and hold  (small flame) button to decrease flame height or to set the appliance at pilot flame.
- For fine adjustment tap the  (large flame) or  (small flame) buttons.

Express LO and HI Fire

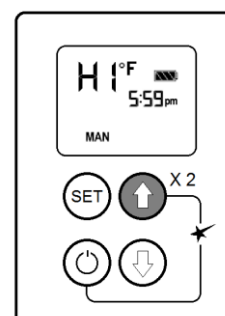

- Double-click  (small flame) button. "LO" will be displayed. NOTE: Flame goes to high fire first before going to designated low fire.



- Double-click  (large flame) button. Flame automatically goes to high fire. "HI" will be displayed.

SETTING C/24 HOUR OF F/12 HOUR

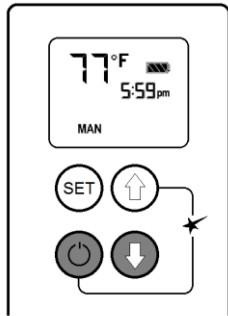

- In MAN mode, press OFF and (small flame) buttons until display changes from Fahrenheit/12-hour clock to Celsius/24-hour clock and vice versa.

SETTING THE TIME

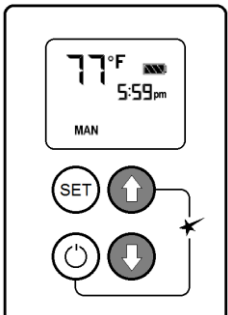

- The time display will flash after either: Installing the battery or simultaneously pressing the (large flame) and (small flame) buttons
- Press (large flame) button to set the hour.
- Press (small flame) button to set the minute.
- Press OFF or simply wait to return to MAN mode.

MODES OF OPERATION

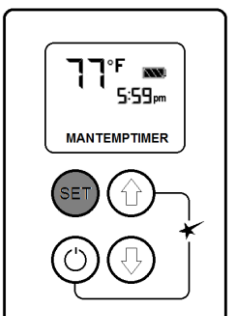

- Briefly pressing the SET button changes the mode of operation in the following order:

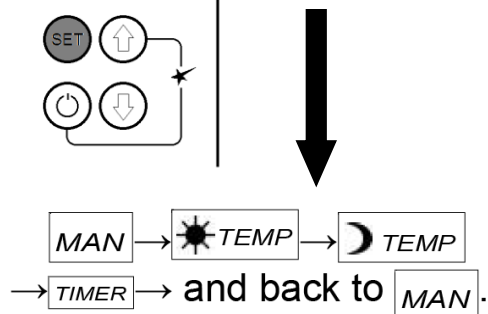

NOTE: Manual mode can also be reached by pressing either the (large flame) or the (small flame) buttons. **Whatever mode the remote is left in (MAN, TEMP, TIMER) is the mode the appliance will operate in until the mode is manually changed.**

MANUAL MODE

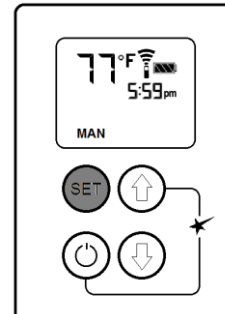

- In MAN mode, flame height is controlled by the up and down arrows. HO and LO commands function but otherwise is a “more or less flame” mode only.

DAYTIME TEMP MODE

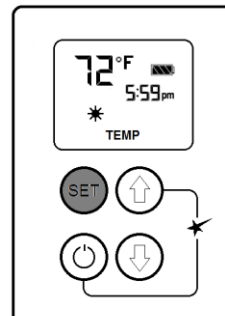

- (Appliance must be in standby mode; pilot ignited) - The room temperature is measured and compared to the set temperature. The flame height is then automatically adjusted to achieve the Daytime Set Temperature.

NIGHTTIME SETBACK TEMP MODE

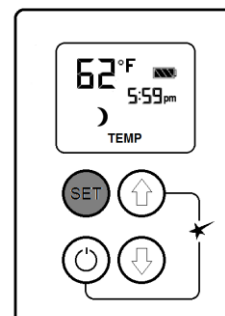

- (Appliance must be in standby mode; pilot ignited) - The room temperature is measured and compared to the set temperature. The flame height is then automatically adjusted to achieve the Nighttime Setback Temperature.

TIMER MODE

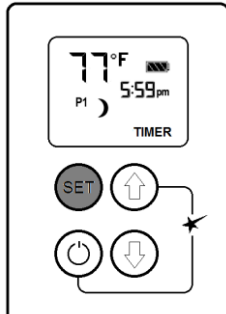

(Appliance must be in standby mode; pilot ignited)
The timers P1 and P2 (Program 1, Program 2) each can be programmed to go ON and OFF at specific times. For instructions see Timer Programming Mode.

NOTE: The display shows the set temperature every 30 seconds.

SETTING ON/OFF TEMPERATURES

SETTING THE “DAYTIME” TEMPERATURE

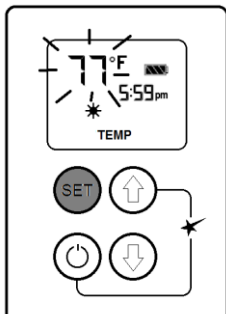

- Briefly press SET button to scroll to TEMP (sun) mode. Once there, hold the SET button down until the TEMP flashes.

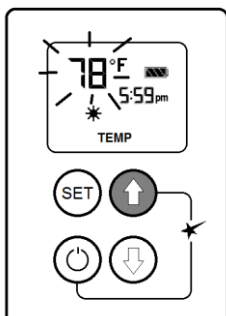

- Press (large flame) button to increase the Daytime Set Temperature or press (small flame) button to decrease Daytime Set Temperature.
- When finished, press OFF or wait for remote to re-set.

SETTING “NIGHTTIME SETBACK” TEMPERATURE

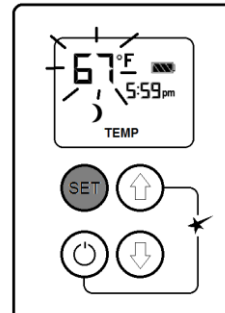

- Briefly press SET button to scroll to TEMP (moon) mode. Once there, hold the SET button until the TEMP flashes.

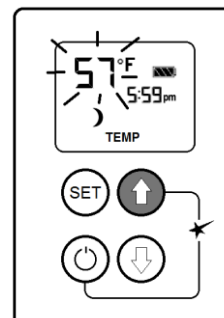

- Press (large flame) button to increase the Nighttime Set back Temperature or press (small flame) button to decrease Nighttime Setback Temperature.
- When finished, press OFF or wait for remote to re-set.

Tip

Set the different parameters only when they are flashing. For the Nighttime setback mode, pressing the down arrow until the LCD reads “- -” turns the Nighttime Setback Temp feature off.









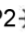

SETTING PROGRAM TIMERS

Program timer mode allows the user to program a set time of day during which the appliance will operate to maintain a preset temperature (the Daytime Temp set above). When the appliance is not operating within this programmed time, it will revert to the Nighttime Setback Temp as programmed above.

Default settings:

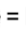
Program 1: P1	6:00 am	P1	8:00 am
Program 2: P2	11:50 pm	P2	11:50 pm

Additional Information:

- 2 ON times can be programmed  per day.
- C/24hr. mode: The day starts at 0:00, ends at 23:50.
- F/12hr. mode: The day starts at 12:00^{am}, ends at 11:50^{pm}.
- The ON/OFF times have to be programmed in the order $P1 \text{  } \leq P1 \text{  } < P2 \text{  } \leq P2 \text{  }$.
- If $P1 \text{  } = P1 \text{  }$ or $P2 \text{  } = P2 \text{  }$ the timer is deactivated.
- To have the fire over night, it can be set:
C/24hr. mode: $P2 \text{  } 23:50$ and $P1 \text{  } 0:00$
F/12hr. mode: $P2 \text{  } 11:50^{\text{am}}$ and $P1 \text{  } 12:00^{\text{am}}$

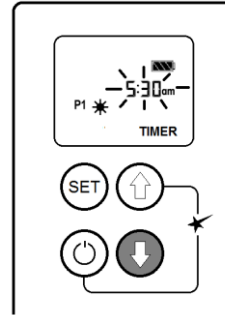

- Press the small flame arrow  to set the minute.

Setting P1 On Time:

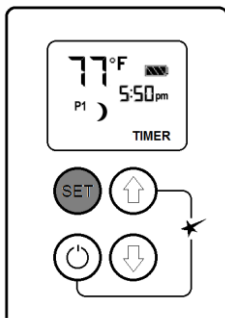

- Briefly press SET button to scroll to TIMER mode. P1 and the moon icon will also appear on the screen.

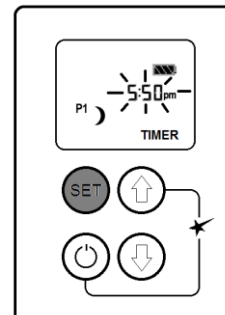

- Briefly press SET button to scroll to TIMER P1 mode (moon) while the time is still flashing.

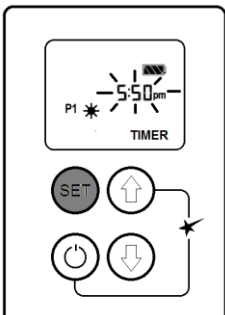

- Once there, hold the SET button down until the time of day flashes.

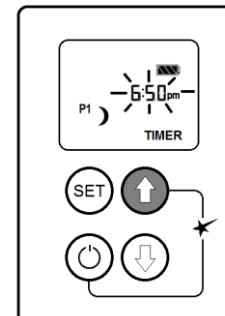

- Press the large flame arrow  to set the hour.

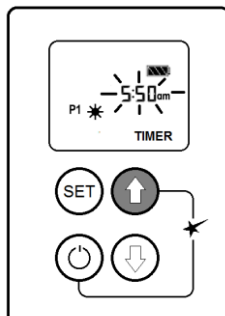

- Press the large flame arrow  to set the hour.

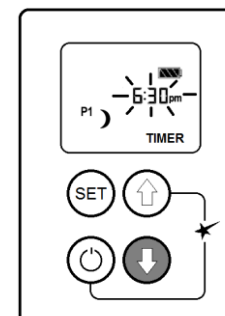

- Press the small flame arrow  to set the minute.

Setting P2 On Time

- While the time of day is still flashing, briefly press SET to scroll to TIMER mode **P2**  (sun).

- Follow the instructions given to set P1 ON time.

Setting P2 Off Time

- While the time of day is still flashing, briefly press SET to scroll to TIMER mode **P2** (moon).
- Follow the instructions given to set P1 OFF time.

Programming Example:

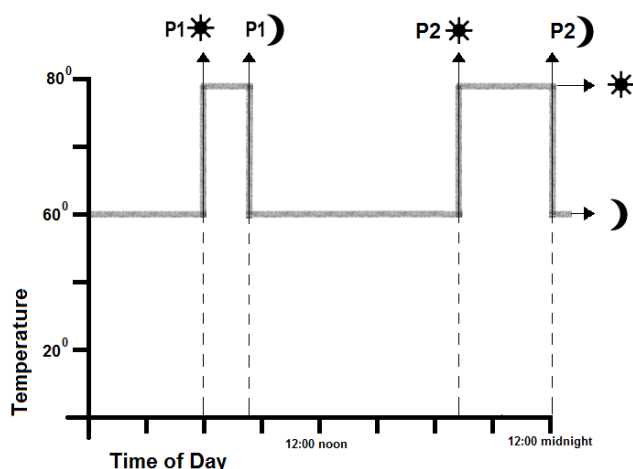

Appliance set to the following conditions will:

Increase temperature to 78 degrees from 6am to 8:45am each day, then return to 60 degrees until 7:30pm, at which time it will increase to 78 degrees until 12:00am, when it will return to 60 degrees and modulate there until 6:00am the following morning.

☀ Daytime temp set to 78°

☾ Nighttime temp set to 60°

P1☀ Program 1 daytime timer set to 6:00am

P1☾ Program 1 nighttime timer set to 8:45am

P2☀ Program 2 daytime timer set to 7:30pm

P2☾ Program 2 nighttime timer set to 12:00am

Tip

If you want to program only one period, program **P1** day and **P1** night with desired times and program **P2** day and **P2** night with the same time.

AUTOMATIC TURNDOWN

- No communication.** If there is no communication between the receiver and the

handset for a period of 6 hours, the appliance goes into pilot mode.

- No change in flame height.** If there is no change in flame height for a period of 6 hours, the appliance goes into pilot mode.

NOTE: In **TEMP** or **TIMER** modes, the flame height will vary according to room temperature. The appliance will continue to work normally. However, if the room temperature remains the same for 6 hours, the appliance will go into pilot mode.

AUTOMATIC SHUT OFF

- Low batteries in the receiver.** With low battery power in the receiver the system shuts off completely.

NOTE: This does not apply when the power supply is interrupted.

- No change in pilot.** The appliance shuts off completely when it is continually in pilot position— without any change—for a period of 5 days.

LOW BATTERY INDICATION

CAUTION

DO NOT USE a screwdriver or other metallic object to remove the batteries from the battery box or the handset! This could cause a short circuit.

- Remote handset:** The battery icon  will show when the battery needs to be replaced. Replace with one 3 “AAA” **alkaline** batteries.
- Receiver:** Three short ‘beeps’ will sound when the motor turns when the batteries need to be replaced. Replace with four 1.5 V **alkaline** batteries.
- HANDSET / RECEIVER MATCH**
The remote control handset and receiver are program- med to function together. In case of a replacement of the handset or the receiver, you will need to reset the receiver to allow them to function together. Contact your dealer for details.

GAS CONVERSION

These appliances are field convertible between Propane to Natural gas when an AURORA gas conversion kit is used. Gas conversions must be performed by a qualified service technician.

PART #	DESCRIPTION	AURORA CONVERSION KIT CONTENTS			
99-56301	CELESTE/GEMINI 48 LP CONVERSION KIT	#27 PILOT ORIFICE	#49 LP BURNER ORIFICE – 1PC		#8 SCREW – 1PC
99-56300	CELESTE/GEMINI 48 NG CONVERSION KIT	#35 PILOT ORIFICE	#42 NG BURNER ORIFICE – 1PC	NG COLLAR – 1PC	#8 SCREW – 1PC
99-56401	CELESTE/GEMINI 60 LP CONVERSION KIT	#27 PILOT ORIFICE	#56 LP BURNER ORIFICE – 2PCS		#8 SCREW – 2PCS
99-56400	CELESTE/GEMINI 60 NG CONVERSION KIT	#35 PILOT ORIFICE	#49 NG BURNER ORIFICE – 2PCS	NG COLLAR – 2PCS	#8 SCREW – 2PCS
99-56501	CELESTE/GEMINI 72 LP CONVERSION KIT	#27 PILOT ORIFICE	#55 LP BURNER ORIFICE – 2PCS		#8 SCREW – 2PCS
99-56500	CELESTE/GEMINI 72 NG CONVERSION KIT	#35 PILOT ORIFICE	#46 NG BURNER ORIFICE – 2PCS	NG COLLAR – 2PCS	#8 SCREW – 2PCS

Before servicing the appliance, shut off gas and electrical power to the unit. To access the burner(s), follow the screen and glass removal procedure shown on pages 21-22.

1. The burner(s) are retained by #10 sheet metal screws, using a 5/16" nut driver, remove these screws. (8 screws in the 48 and 60 inch models; 12 screws in the 72 inch).
2. The 60 and 72 inch models have a burner link that aligns the burners, remove the (2) #10 sheet metal screws.
3. Lift off the pilot hood.
4. The Pilot assembly is retained by (2) #10 sheet metal screws.
5. After removing the screws retaining the pilot assembly, lift the pilot assembly into the firebox.
6. Using a 10mm wrench, remove the pilot gas line to swap the orifice.
7. Once the pilot gas line is tight, reinstall the pilot assembly making sure the gasket is intact.

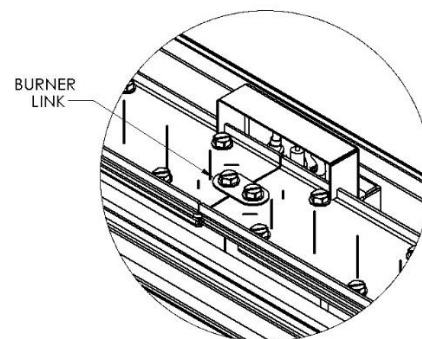

8. When converting from Propane to Natural Gas, slide the NG Collar over the Burner inlet tube and use a 1/4" nut driver to secure with a #8 sheet metal screw.
9. When converting from Natural Gas to Propane, remove the NG Collar from the burner inlet tube.
10. Using a 9/16" deep socket, replace the burner orifice(s) in the firebox with those provided in the conversion kit.
11. Reinstall the burner(s) in the fireplace. Reinstall the burner link if required.
12. Using a flat screw driver, remove the Pressure Conversion Plug and set it to NG or LP accordingly.



Gas Flow Adjustment

1. Install a gas pressure gage on the outlet pressure tap on the valve.
2. Light the fireplace using the remote handset.
3. With the fireplace on high, set the maximum pressure by adjusting the small flat screw set within the Pressure Conversion Plug. Refer to chart below for high pressure settings. (it may be necessary to lift the valve control bracket up out of the fireplace to access the pressure tap and minimum rate orifice)
4. double tap the down arrow to set the fireplace to low. "Lo" will momentarily appear on the display.
5. The minimum rate can be set by adjusting the minimum rate orifice. Refer to the chart below for Low pressure settings.
6. Close the pressure tap(s) by turning the screws clockwise. Check all connections/pressure taps for leaks.

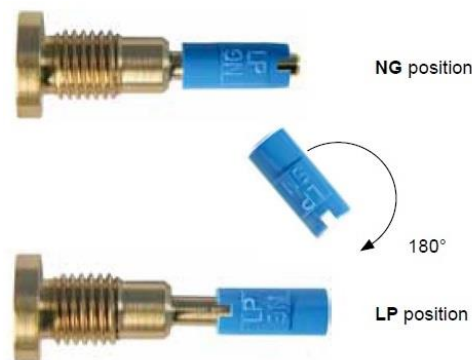
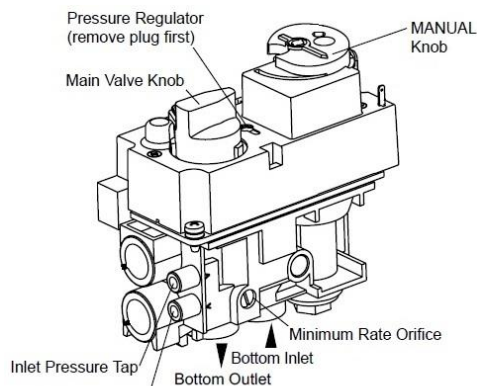

MODEL	HIGH PRESSURE (NG)	LOW PRESSURE (NG)	HIGH PRESSURE (LPG)	LOW PRESSURE (LPG)
CEL/GEM 48	3.9" w.c. /1.0kPa	1.9" w.c. /0.47kPa	10.0" w.c. /2.5kPa	4.7" w.c. /1.17kPa
CEL/GEM 60	3.9" w.c. /1.0kPa	1.9" w.c. /0.47kPa	10.0" w.c. /2.5kPa	4.7" w.c. /1.17kPa
CEL/GEM 72	3.9" w.c. /1.0kPa	2.2" w.c. /0.55kPa	10.0" w.c. /2.5kPa	4.7" w.c. /1.17kPa

Maintenance

ANNUAL MAINTENANCE

A qualified service agency should conduct an annual inspection and maintenance of your AURORA Gas Fireplace including the overall installation and venting to keep it running safely. The following procedures should be performed only by a qualified service person. The gas supply should be turned off and the stove should be completely cool whenever a maintenance procedure is performed. All parts of the appliance that are removed for servicing must be replaced prior to operation.

This appliance should be inspected before use and at least annually by a qualified service person. More frequent cleaning may be required due to excessive dust or lint from carpeting, bedding materials, pets, etc. It is imperative that control compartments and circulating air passageways of this appliance be kept clean.

CLEANING THE BURNER AND FIREBOX

During the annual inspection and maintenance appointment, the service person should clean the burner and firebox. To gain access to the firebox and burner, follow the instructions beginning on page 18 of this manual.

DO NOT USE A VACUUM CLEANER TO CLEAN THE GLASS BURNER MEDIA.

A vacuum cleaner may be used to clean the metal parts of the firebox. Leave the glass burner media in place. Use a soft brush to clean the burner glass media. If the burner media does need to be removed, carefully scoop it off the burner and avoid dropping glass pieces in the air gaps around the burner. Follow the instructions on page 22 of this manual when replacing the burner media on the burner top.

AIR FLOW

The AURORA Gas Fireplace utilizes a convection air heat exchange system to maximize heat delivered from the fireplace. It is important that air flows freely through the convection air system and out the air grills. Do not place objects against the fireplace that will block the convection air inlet flow or in front of any air outlet.

CLEANING THE GLASS AND GLOSS BLACK ENAMEL PANELS

After allowing the Fireplace to cool, use an ammonia-free glass cleaner and a soft, clean cloth to clean the Enamel Panels at the rear and side of the firebox. It is recommended that the Glass Enamel Panels be cleaned at least annually to avoid discoloration. More frequent cleaning may be required if contaminants are present in the gas supply or general atmosphere.

WARNING: Never clean the Glass or Enamel Panels while they are hot. Do not use abrasive cleaners or cleaners containing ammonia.

NOTE: It is recommended that a Micro-fiber cleaning cloth be used to clean the glass and enamel panels.

Synchronizing the Remote and Valve Receiver Module

A code is selected automatically for all Mertik Maxitrol electronics from among 65,000 random codes available. The receiver must learn the code of the handset, which is performed at the factory. If for any reason your appliance stops responding to remote commands, it may be necessary to re-sync the two components. To access the Valve Receiver Module, follow the instruction on pages 35-36. Once you have access to the Receiver, press and hold the receiver's reset button (*see figure below*) until you hear two (2) beeps. The first beep is short

and the second beep is long. After the second beep, release the reset button. Within 20 seconds press the Small Flame button on the handset until you hear two additional short beeps confirming the code is set. If you hear one long beep, this indicates the code has failed or the wiring is incorrect.



Step 1: Locate Reset Button on Receiver



Step 2: Press and hold Reset button until second beep is finished

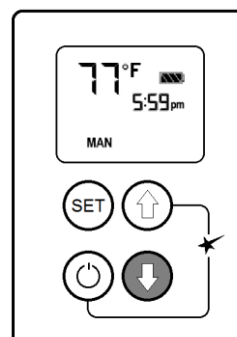

Step 3: Within 20 seconds, press Small Flame button on the remote

Maintenance Log

We strongly recommend that you keep a log of the regular maintenance that is performed on your fireplace. We have provided the forms below to make it easy. Simply ask your qualified service person to fill out one of the maintenance record forms below, each time the fireplace is serviced. This will help insure that all of the required maintenance procedures have been completed, at least annually. Regular maintenance will help keep the fireplace functioning in a safe and reliable manner. Additional forms are available from your installer or service person when needed.

Date of Service _____
Serviced By _____

Service Performed

- ☐ Inspect Venting
- ☐ Clean Burner & Firebox
- ☐ Clean Control Area
- ☐ Clean Convection Air System
- ☐ Leak Test Gas Connections
- ☐ Other _____

Date of Service _____
Serviced By _____

Service Performed

- ☐ Inspect Venting
- ☐ Clean Burner & Firebox
- ☐ Clean Control Area
- ☐ Clean Convection Air System
- ☐ Leak Test Gas Connections
- ☐ Other _____

Date of Service _____
Serviced By _____

Service Performed

- ☐ Inspect Venting
- ☐ Clean Burner & Firebox
- ☐ Clean Control Area
- ☐ Clean Convection Air System
- ☐ Leak Test Gas Connections
- ☐ Other _____

Date of Service _____
Serviced By _____

Service Performed

- ☐ Inspect Venting
- ☐ Clean Burner & Firebox
- ☐ Clean Control Area
- ☐ Clean Convection Air System
- ☐ Leak Test Gas Connections
- ☐ Other _____

Date of Service _____
Serviced By _____

Service Performed

- ☐ Inspect Venting
- ☐ Clean Burner & Firebox
- ☐ Clean Control Area
- ☐ Clean Convection Air System
- ☐ Leak Test Gas Connections
- ☐ Other _____

Date of Service _____
Serviced By _____

Service Performed

- ☐ Inspect Venting
- ☐ Clean Burner & Firebox
- ☐ Clean Control Area
- ☐ Clean Convection Air System
- ☐ Leak Test Gas Connections
- ☐ Other _____

Installation Record

The installer should complete the form below that describes the details of the installation. Having this written record of installation information available will greatly expedite trouble-shooting should any problem arise with your stove. The installer should keep a duplicate of this form for their records.

Date Purchased: _____

Dealer: _____

Date Installed: _____

Installer: _____

Fireplace Model: (circle one) GEMINI 48 CELESTE 48 GEMINI 60 CELESTE 60
 GEMINI 72 CELESTE 72

Serial Number: _____ in. WC

Fuel: (circle one) Natural Gas (NG) Propane (LP)

Inlet Pressure (after installation): _____

Manifold Pressure (after Installation): High Fire: _____ in. WC
 Low Fire: _____ in. WC

Altitude: (feet above sea level) _____

Was the stove de-rated? (circle one) Yes No

If the stove was de-rated, to what orifice size? _____

Other installation notes: _____

CONTROL SYSTEM SCHEMATIC

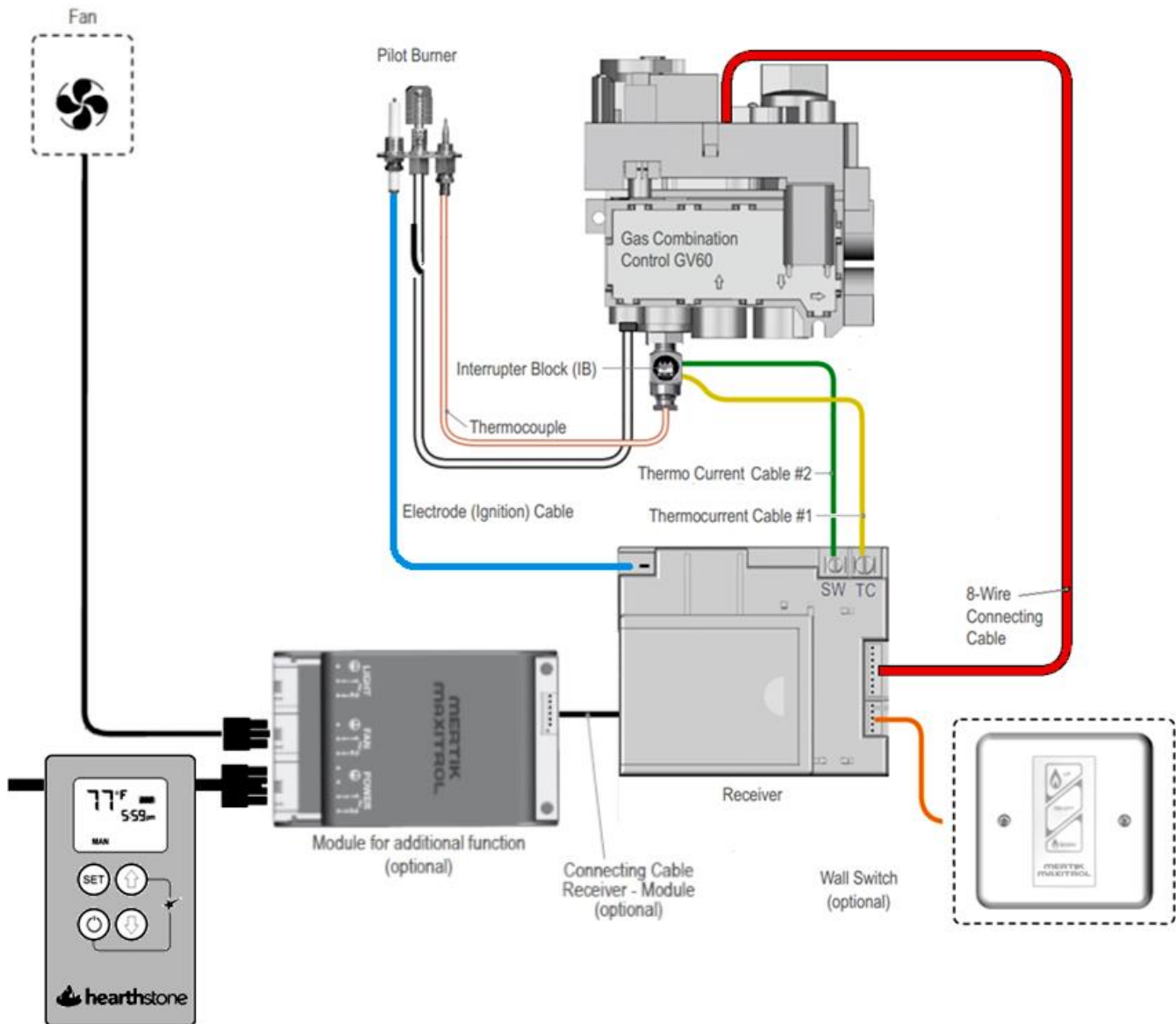

Caution: Label all wires prior to disconnection when servicing the controls. Wiring errors can cause improper and dangerous operation. Verify proper operation after servicing.

Replacement Parts List

PART NAME	P/N	PART NAME	P/N
Natural Gas (NG) Pilot Assy.	BI-401	TC Line Red	7000-069
Propane (LP) Pilot Assy.	BI-402	TC Line Yellow	7000-068
Receiver Module (Maxitrol)	7000-381	Thermocouple Interrupter Block	7000-067
Wall Switch Panel (Optional)	7000-260	8-Wire Connecting Cable	7000-044
Remote Handset (Maxitrol)	7000-362	Gas Valve (Maxitrol)	7211-308
Module for Additional Function	7000-382	Replacement Blower	99-57100
See-Thru Firebox Side Panel	99-76300	Single-Side Firebox Side Panel	99-76350
Firebox Enamel Panel – Rear	99-76351	Blower Wire Harness (Single Side)	7000-078
Blower Wire Harness (See-Thru)	7000-077	LH & RH Trim panel (1 set)	5930-540

CELESTE/GEMINI 48 - REPLACEMENT PARTS

PART NAME	P/N	PART NAME	P/N
Burner Orifice (NG)	7200-214	Burner (NG)	99-74300
Burner Orifice (LP)	7200-215	Burner (LP)	99-74301
Burner Glass Media (Ebony)	7211-756	Burner Conversion Kit (NG)	99-56300
Burner Conversion Kit (LP)	99-56301	Air Flow Trim Panel	5930-550

CELESTE/GEMINI 60 - REPLACEMENT PARTS

PART NAME	P/N	PART NAME	P/N
Burner Orifice (NG)	7200-216	Firebox Enamel Panel - End	99-76400
Burner Orifice (LP)	7200-217	Burner Module (NG) (2 req.)	99-74400
Burner Glass Media (Ebony)	7211-757	Burner Module (LP) (2 req.)	99-74401
Burner Conversion Kit (NG)	99-56400	Burner Conversion Kit (LP)	99-56401

CELESTE/GEMINI 72 - REPLACEMENT PARTS

PART NAME	P/N	PART NAME	P/N
Burner Orifice (NG)	7200-218	Firebox Enamel Panel - Center	99-76500
Burner Orifice (LP)	7200-219	Burner Module (NG) (2 req.)	99-74500
Burner Glass Media (Ebony)	7211-768	Burner Module (LP) (2 req.)	99-74501
Burner Conversion Kit (NG)	99-56500	Burner Conversion Kit (LP)	99-56501

For replacement parts and customer service, contact your Aurora dealer or:

Hearthstone Quality Home Heating Products, Inc.

Technical Services

317 Stafford Avenue

Morrisville, VT 05661

www.hearthstonestoves.com

Troubleshooting

Symptom	Possible Cause	Corrective Action
1. Pilot will not light.	<p>A. Optional Power supply not plugged in and/or batteries are dead.</p> <p>B. Insufficient gas pressure, air in the pilot line, or dirty or kinked gas line.</p> <p>C. Pilot orifice plugged.</p> <p>D. Defective or misaligned igniter element in pilot assembly.</p> <p>E. Defective igniter.</p> <p>F. After sitting for "off" season (summer), pilot assembly may be dirty.</p>	<p>A. Ensure power supply is plugged in and receiving 120V AC. Replace all batteries with known good batteries.</p> <p>B. Allow time for system to purge air in line. Check the inlet gas pressure. Make sure it is within the Min/Max. allowable pressures.</p> <p>C. Clean or replace the pilot assembly.</p> <p>D. If a flame lights the pilot, check the electrode gap and location. The gap should be 1/8" in the flame area.</p> <p>E. Check for a good connection between igniter and electrode. Check wire insulation. If everything is properly connected and still no spark, replace the Ignition Module.</p> <p>F. Clean or replace the pilot assembly.</p>
2. Pilot in Manual or Standby mode and will not stay lit after carefully following lighting instructions.	<p>A. Low or too high gas pressure</p> <p>B. Faulty connections.</p> <p>C. Pilot dirty or plugged.</p> <p>D. Thermocouple damaged.</p> <p>E. Thermocouple Interrupter circuit damaged.</p>	<p>A. Check for proper inlet pressure for the fuel gas in use.</p> <p>B. Check connections on the valve.</p> <p>C. Clean or replace the pilot assembly.</p> <p>D. Check for appropriate MV at thermocouple interrupter.</p> <p>E. Check thermocouple interrupter circuit for damage or loose connections.</p>
3. Pilot burning, no gas to main burner.	<p>A. Gas control system may be damaged.</p> <p>B. No power and/or batteries may be dead.</p> <p>C. Plugged burner orifice.</p>	<p>A. Check wiring for proper connections. Check components for proper operation. Check for appropriate MV output from thermocouple and check connections at thermocouple interrupter.</p> <p>B. Restore 120V service or replace batteries in receiver.</p> <p>C. Inspect burner.</p>
4. Pilot and burner come on, but go out after some warm-up.	<p>A. Inconsistent draft.</p> <p>B. Insufficient gas pressure.</p> <p>C. Excessive draft.</p>	<p>A. Check flue for blockage or other damage to venting.</p> <p>B. Check line pressure to ensure that the correct inlet pressure is present for the type of gas being used. If propane pressure is inconsistent, check for water condensation at the regulator.</p> <p>C. Check Restriction settings per this manual.</p>

Symptom	Possible Cause	Corrective Action
5. Frequent pilot outage.	A. Pilot flame may be too low or blowing, (high), causing the pilot safety to drop out. B. Excessive draft	A. Clean and/or adjust the pilot flame for maximum impingement on the thermocouple. B. Check Restriction settings per this manual.
6. Glass fogs	A. A normal result of gas combustion in a cold stove.	A1. After the heater has warmed up, the glass should clear. A2. Leave pilot in standby mode to keep stove warmer.
7. Blue Flames	A. A normal result during the first 20 minutes.	A. Flames should begin to turn more yellowish after 20 minutes of burning. B. If the blue color stays; adjust the air shutter for a proper burn.
8. Floating flames, lazy ill-defined, quiet flames, which roll around, sometimes completely off of the port, sometimes with overly, yellow tips. Possible sooting. Usually accompanied by the odor of aldehydes.	A. Potentially dangerous incomplete combustion due to incorrect air to fuel ratio (lack of combustion air or excessive fuel delivery I.e. excessive gas pressure, overrating of appliance). B. Incorrect air intake/exhaust flow system. Causes may be: B1. Blocked burner. B2. Blocked primary air B3. Blocked secondary air inlets C. Incorrect vent restrictor setting.	A. Check the appliance input rate and reduce if necessary. The air intake/exhaust flow system may be too restrictive or blocked (the rate at which the exhaust leaves [draft] determines the rate at which the combustion air is delivered). Poor draft results in insufficient air delivery or a restricted exhaust. Correct air intake/exhaust flow system. B1. Clear ports. B2. Clear obstructions. B3. Clear obstructions. C. If gas pressures are correct and the flames stay the same, check vent restrictor settings for a proper burn.
9. Burner flashback. Air-gas mixture ignites inside the burner near the orifice, usually creating a roaring noise like a blowtorch. The problem is an imbalance of gas flow velocity and burning speed pattern.	A. Excessive primary air. B. Burner input underrated. C. Valve leak if flashback occurs with burner valve in off position. D. Improper gas pipe size.	A. Adjust the air shutter for a proper burn. B. Check input rate. Check input pressure using a manometer. Confirm correct gas pressure at house meter or tank (call gas company). Confirm burner orifice size. C. Replace valve. If above corrections do not eliminate flashback, replace burner. D. Correct plumbing.
10. Delayed ignition (makes a sudden "whoosh" noise as the burner lights). This is a buildup of gas prior to ignition. This is more prevalent with propane (LP) fuel.	A. Incorrect air-to-fuel ratio. A1. Primary air incorrect. A2. Burner ports plugged.	A1. Adjust the air shutter for a proper burn. A2. Open ports to allow for proper travel of flames. B. Reposition media to eliminate interference with flame travel.

Limited Warranty

These warranties give you specific legal rights. You may also have other rights which vary from State to State.

Hearthstone Quality Home Heating Products, Inc. (Hearthstone) warrants to the original retail purchaser only (the "Original Purchaser") the new appliance manufactured by Hearthstone, purchased by the Original Purchaser and installed by an authorized Hearthstone dealer or their designated representative against any of the occurrences listed in this document that result from defects in material or workmanship. This warranty is not transferrable. All obligations of Hearthstone under this document commence on the date of the Original Invoice (the "Purchase Date"). The term "Limited Lifetime" is defined as 10 years from the beginning of warranty coverage.

Hearthstone appliances are designed to be operated only with the fuels listed in your owner's manual.

Burner – Repair or replacement for three years from date of installation.

Gas components & electrical components – Repair or replacement for one year from date of installation.

Blowers & remote controls – Repair or replacement for one year from the date of installation.

Porcelain Firebox Liners – Replacement for one year against cracking or breakage due to thermal stress from date of installation. Excludes surface and hairline cracks and scratches or slight color changes that do not affect the operation or safety of the unit.

Gaskets – Repair or replacement for one year from the date of installation.

Surrounds – Replacement for one year against cracking or breakage due to thermal stress. Excludes surface and hairline cracks and scratches or slight color changes that do not affect the operation or safety of the unit.

Any parts repaired or replaced during the limited warranty period will be warranted under the terms of the limited warranty for a period not to exceed the remaining term of the original limited warranty or one year, whichever is longer.

Parts: Hearthstone will replace through an authorized dealer, defective parts covered by the foregoing warranty at no charge.

Labor: Within the first (1st) year after the Purchase Date, Hearthstone will pay for warranty labor performed by an authorized Dealer at Hearthstone's published labor rates in effect at the time the labor is performed only if the appliance is installed by an authorized dealer or their designated representative. Otherwise or thereafter, the Original Purchaser is responsible for the cost of labor.

Shipping cost for parts: Within the first ninety (90) days after the Purchase Date, Hearthstone will pay for the shipping of appliance parts covered by any of the foregoing warranties to and from Hearthstone or an authorized Dealer, as the case may be. Thereafter, the Original Purchaser is responsible for all shipping costs related to shipping appliance parts to and from Hearthstone or an authorized Dealer, as the case may be.

Shipping cost for the appliance: Within the first (1st) year after the Purchase Date, if the Original Purchaser is instructed to return the appliance to Hearthstone or an authorized Dealer for repair, Hearthstone will pay fifty percent (50%) and the Original Purchaser will pay fifty percent (50%) of the shipping costs related to shipping the appliance to and from Hearthstone or an authorized Dealer, as the case may be. Thereafter, the Original Purchaser is responsible for one hundred percent (100%) of all of the shipping costs related to shipping the appliance to and from Hearthstone or an authorized Dealer, as the case may be. Notwithstanding any other provision of this document, in no event will Hearthstone pay for any Dealer fees or other fees for pick up or delivery of the appliance returned for repair; the Original Purchaser shall be responsible for any such fees.

EXCLUSIONS & CONDITIONS

The warranties contained in this document do not cover, nor is Hearthstone responsible for:

1. Damages resulting from:
 - a. Failure to install, operate, or maintain the appliance in accordance with the owner's manual, operating instructions, installation instructions, or safety rating label provided with the appliance.
 - b. Over-firing the appliance. Over-firing can be identified by, but not limited to, warped cast iron or steel, rust colored cast iron, bubbling, cracking and discoloration of steel or enamel finishes.
 - c. Failure to install the appliance in accordance with all national or local building codes.
 - d. Shipping or improper handling.
 - e. Improper operation, abuse, misuse, continued operation with damaged, corroded, or failed components, accident, or improper/incorrect service or repairs.
 - f. Environmental conditions, inadequate ventilation, negative pressure, or improper drafting caused by tightly sealed constructions, insufficient make-up air supply, or air handling devices such as exhaust fans, forced air furnaces, or other such causes.
 - g. Damage caused by direct exposure to water.
 - h. Use of fuels other than those specified in the owner's manual.
 - i. Installation or use of components not supplied with the appliance, or any other components not expressly authorized and approved by Hearthstone.
 - j. Modifications of the appliance not expressly authorized and approved by Hearthstone in writing
 - k. Interruptions or fluctuations of electrical power supplied to the appliance.
2. All stones are warranted against cracking or breakage due to thermal stress, excluding surface and hairline cracks and scratches that do not affect the operation, or safety of the appliance.
3. Repair or replacement of wear parts. Such parts that are subject to normal wear and tear during the warranty period such as paint, gaskets, baffles, refractory materials, ash grates, and glass.
4. Damage resulting from installation, modification, alteration, repair or service of the appliance by any party other than an authorized Hearthstone dealer (a "Dealer") or their designated representative, or Hearthstone.
5. Damage due to water or condensation due to installation of the appliance in a high moisture area.
6. Damage due to installation of the appliance in an atmosphere contaminated by damaging chemicals, including but not limited to chlorine, fluorine or salts.
7. Scratches on glass, enameled surfaces or stones due to mechanical abrasion.
8. Noise caused by expansion or contraction caused by the heating and cooling of the appliance.
9. Odors caused by the heating of the appliance, or surrounding materials
10. Consequential damage caused by leaking of condensate during startup
11. A defect in any part of the appliance if the Original Purchaser fails to comply with Hearthstone's or a Dealer's request to ship the part or the appliance to Hearthstone or a Dealer, as the case may be.
12. Replacement stones and enameled parts are taken from current stock, and may not match originals in color, grain, or pattern. Hearthstone will supply replacement parts for discontinued parts in finishes or colors as available, or at their discretion.
13. Hearthstone's obligation under this warranty does not extend to the appliance's ability to heat the desired space. Information is provided to assist the customer and the dealer in selecting the appropriate appliance for the application. Consideration must be given to appliance location and configuration, environmental conditions, insulation and air tightness of the structure.

THE WARRANTIES CONTAINED IN THIS DOCUMENT ARE EXCLUSIVE AND ARE GIVEN BY HEARTHSTONE AND ACCEPTED BY THE ORIGINAL PURCHASER IN LIEU OF ALL OTHER EXPRESS WARRANTIES AND ANY OBLIGATIONS, LIABILITIES, RIGHTS, CLAIMS, OR REMEDIES IN CONTRACT OR TORT, WHETHER OR NOT ARISING FROM HEARTHSTONE'S NEGLIGENCE, ACTUAL OR IMPUTED. ALL IMPLIED WARRANTIES, INCLUDING THE WARRANTIES OF MERCHANTABILITY AND FITNESS FOR A PARTICULAR PURPOSE, ARE GIVEN ONLY TO THE EXTENT REQUIRED BY FEDERAL OR STATE LAW. EXCEPT AS OTHERWISE REQUIRED BY STATE LAW, UPON THE EXPIRATION OF THE EXPRESS LIMITED WARRANTIES CONTAINED HEREIN, NO IMPLIED WARRANTIES, INCLUDING THE IMPLIED WARRANTIES OF MERCHANTABILITY OR FITNESS FOR A PARTICULAR PURPOSE, SHALL APPLY TO THE SUBJECT APPLIANCE. SOME STATES DO NOT ALLOW LIMITATIONS ON HOW LONG AN IMPLIED WARRANTY LASTS, SO THE ABOVE LIMITATION MAY NOT APPLY TO YOU.

THE WARRANTIES CONTAINED IN THIS DOCUMENT EXTEND ONLY TO THE ORIGINAL PURCHASER OF THE APPLIANCE WARRANTED HEREUNDER. THEY ARE NOT TRANSFERRABLE AND DO NOT EXTEND TO ANY SUBSEQUENT OWNERS.

UNDER NO CIRCUMSTANCES SHALL HEARTHSTONE BE LIABLE TO THE ORIGINAL PURCHASER OR ANY OTHER PERSON FOR ANY INCIDENTAL OR CONSEQUENTIAL DAMAGES, INCLUDING BUT NOT LIMITED TO DAMAGE TO PROPERTY OR PERSONAL INJURIES, WHETHER ARISING OUT OF LOSS OF USE, BREACH OF WARRANTY, TORT, OR OTHERWISE, EVEN IF HEARTHSTONE HAS BEEN APPRAISED OF THE POSSIBILITY OF SUCH DAMAGES. SOME STATES DO NOT ALLOW THE EXCLUSION OR LIMITATION OF INCIDENTAL OR CONSEQUENTIAL DAMAGES, SO THE ABOVE LIMITATION OR EXCLUSION MAY NOT APPLY TO YOU.

QUALIFYING FOR WARRANTY COVERAGE

To obtain performance of any obligation under this document, the Original Purchaser must, within the applicable warranty time period, contact their original Hearthstone dealer, or the current responsible local Hearthstone dealer, for instructions regarding the return of defective parts for repair, the return of the appliance for repair, or to schedule a Dealer service call. The Original Purchaser should refer to the Dealer Network search engine contained on Hearthstone's Web site (www.hearthstonestoves.com) if the original dealer is not available, to find a Hearthstone dealer nearest to the Original Purchaser's location.

REMEDY

The remedy for any breach of the foregoing warranties will consist of repair or replacement, at Hearthstone's option, of any covered defect in the appliance. When the Original Purchaser contacts a Hearthstone Dealer, the Dealer on behalf of Hearthstone, as the case may be, will instruct the Original Purchaser to either return the defective part, or the entire appliance (if requested), to the Dealer or Hearthstone or allow a Dealer to make a service call at the place where the appliance is located. Hearthstone may require that a digital picture be provided to support the claim. Notwithstanding any other provision of this document, the Original Purchaser shall pay for any fees and service charges related to a Dealer's service call or the shipping charges associated with the return.

WARRANTY REGISTRATION

The Original Purchaser can complete their warranty registration on our website at www.hearthstonestoves.com.
Hearthstone's physical address is:

Hearthstone Quality Home Heating Products, Inc.
Warranty Department
317 Stafford Avenue
Morrisville, VT 05661

NOTE: ON-LINE REGISTRATION IS *NOT REQUIRED* AS A CONDITION OF WARRANTY COVERAGE OR HEARTHSTONE'S PERFORMANCE.